

# ATTEN-SMSF-10

---



Inline Attenuator, SMA-m/SMA-f, 10 dB

## Product Classification

**Product Type** Coax attenuator

## General Specifications

**Connector Interface** SMA Female | SMA Male

**Outer Contact Plating** Gold

**Plating** Gold

## Dimensions

**Length** 30 mm | 1.181 in

**Diameter** 10 mm | 0.394 in

# ATTEN-SMSF-10

## Outline Drawing

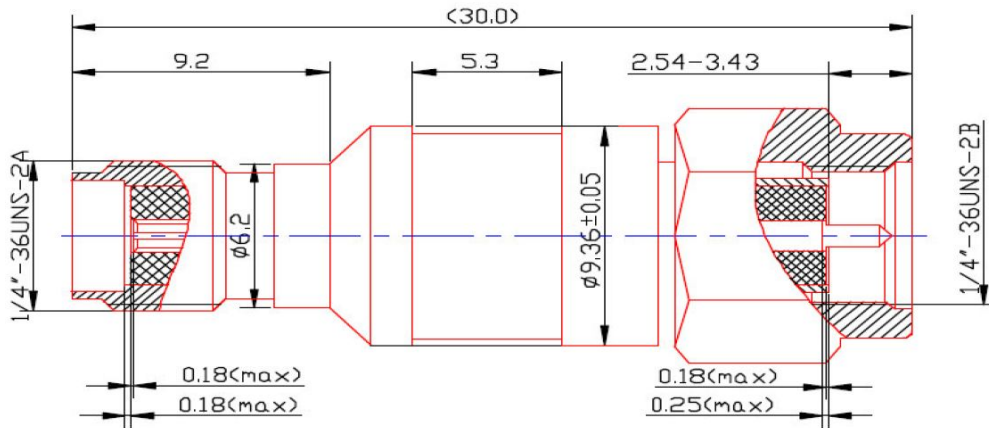

## Electrical Specifications

<b>Input Power, PEP, maximum</b>	100 W
<b>Input Power, RMS, maximum</b>	2 W
<b>Return Loss, minimum</b>	20 dB
<b>Attenuation</b>	10 dB
<b>Attenuation Tolerance</b>	$\pm 0.5$ dB
<b>Impedance</b>	50 ohm
<b>Operating Frequency Band</b>	DC – 3000 MHz

## Material Specifications

<b>Dielectric Material</b>	PTFE
<b>Material Type</b>	Brass
<b>Inner Contact Plating</b>	Gold

## Environmental Specifications

<b>Operating Temperature</b>	-30 °C to +80 °C (-22 °F to +176 °F)
------------------------------	--------------------------------------

## Packaging and Weights

<b>Weight, net</b>	8 g   0.018 lb
--------------------	----------------

## Regulatory Compliance/Certifications

Agency	Classification
--------	----------------

# ATTEN-SMSF-10

---

CHINA-ROHS	Below maximum concentration value
REACH-SVHC	Compliant as per SVHC revision on <a href="http://www.commscope.com/ProductCompliance">www.commscope.com/ProductCompliance</a>
ROHS	Compliant
UK-ROHS	Compliant

