

### Enhanced High Density (EHD) Panel

#### Tools Required and Parts List

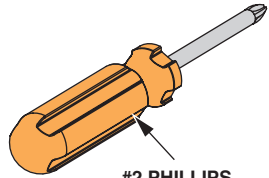

#2 PHILLIPS SCREWDRIVER

PARTS LIST	
QUANTITY	DESCRIPTION
1	EHD PANEL
4	RACK SCREW



EHD PRODUCT PAGE QR CODE; ACCESS WITH SMARTPHONE FOR EHD USER MANUAL AND FIBER CONNECTOR CLEANING INSTRUCTIONS



This document shows the panel being installed on a 19-inch rack.

This document shows the 2RU model in most illustrations. The EHD Panel is also offered in a 1RU and 4RU models. Procedural and physical details are analogous for the 1RU and 4RU models.

1

#### Remove the EHD Panel from the packaging

with accessories and this quick start manual.



There will be cardboard and/or plastic inserts inside of the panel to prevent damage during shipment. Front door and rear cover will need to be opened to remove them.

2

#### Remove the two 23-in. mounting/shipping brackets

The mounting/shipping brackets (one on each side of the panel) are located behind the mounting brackets in the place shown. After being removed from the panel, they can be discarded.

To ease installation, remove the back cover and side plate/gland adapter assemblies.

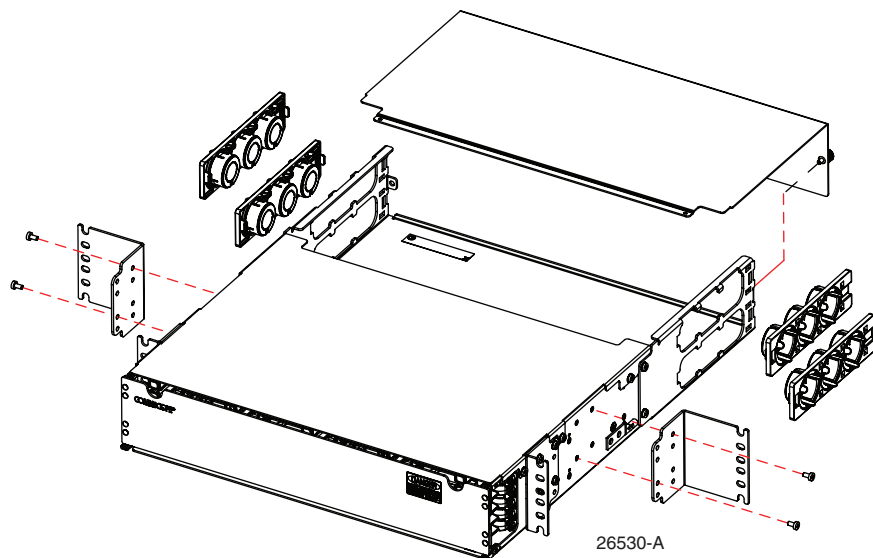

26530-A

3

#### Select Panel Mounting Option to be Used

The EHD panel mounts on the front or rear of a 3-inch or 6-inch channel. The channel can be a frame or the internal front supports of a cabinet.

Ground per local practice in the location shown. Two-hole grounding requires a 0.625-inch spacing between mounting holes (ground lug not included).

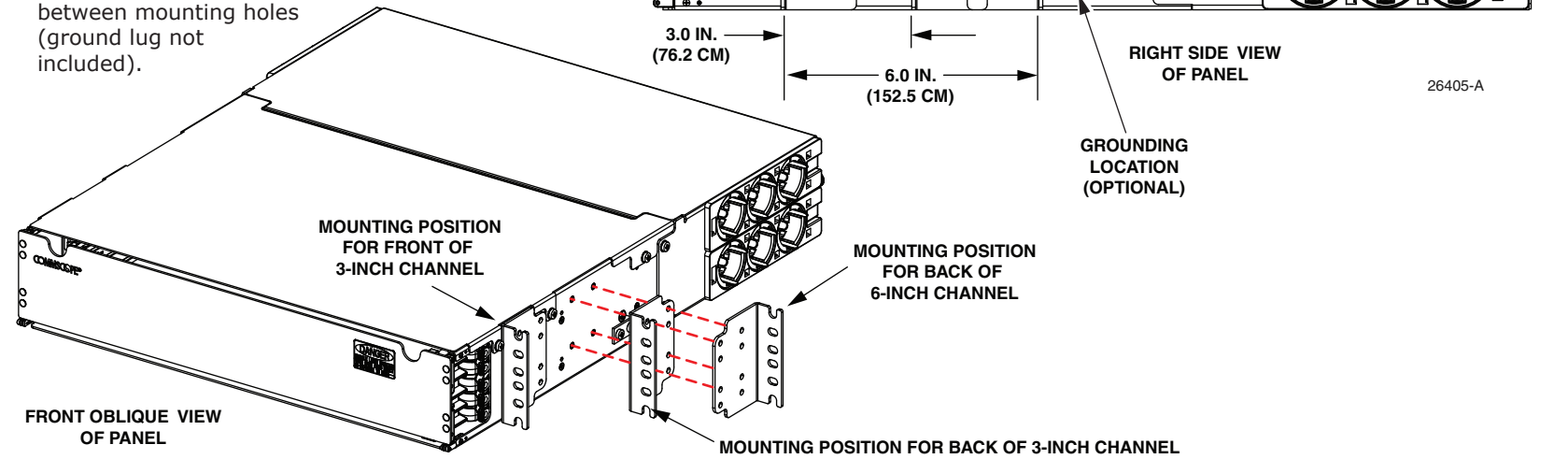

26405-A

4

#### Mount Panel in Channel Rack or Cabinet

Use M6 or #12-24 screws (provided) as appropriate.

##### CHANNEL RACK MOUNTING:

Cable Mounting Bracket (accessory) (EHD-RMB) mounts to rear rail and provides a point to secure trunks.

Vertical Cable Mounting Bracket (accessory) (EHD-RMB-GAB) mounts to rear rail and allows the cable attachment molding to snap into the bracket for top down or bottom up securing of CommScope trunks with gland adapters.

##### CABINET MOUNTING:

It is recommended front and back rails be 24 inches (60.96 cm) apart when mounting with a 3-inch (7.62 cm) recess.

Cable Mounting Bracket (EHD-CMB) mounts to rear rail and provides a point to secure trunks.

Vertical Cable Mounting Bracket (accessory) (EHD-CMB-GAB) mounts to rear rail and allows the cable attachment molding to snap into the bracket for top down or bottom up securing of CommScope trunks with gland adapters.

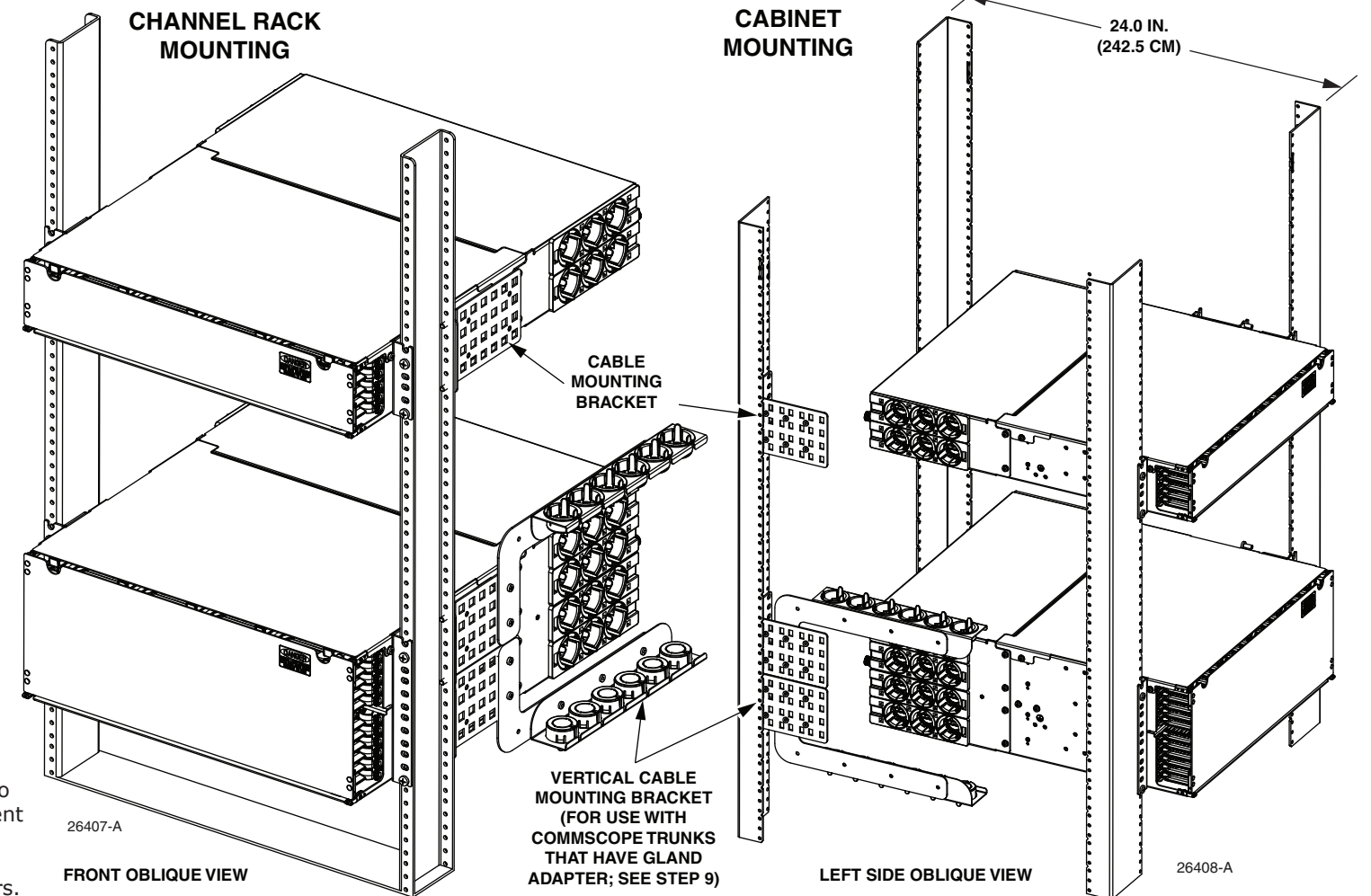

26407-A

FRONT OBLIQUE VIEW

26408-A

LEFT SIDE OBLIQUE VIEW



5

### Slide Out Tray to Mount MPO Module or Adapter Pack

**NOTE:** This step is not necessary at this time if an MPO module or adapter pack is not being installed.

Pull out on pull arm to slide out the blade to the first position, then squeeze as shown to slide the blade to second position.

The rear connectors on MPO adapter packs are able to be unplugged and cleaned in the second blade position.

**NOTE:** Always clean and inspect connectors before mating them. For cleaning instructions, refer to ADCP-90-159, which can be downloaded using the QR code on page 1 of this Quick Start.

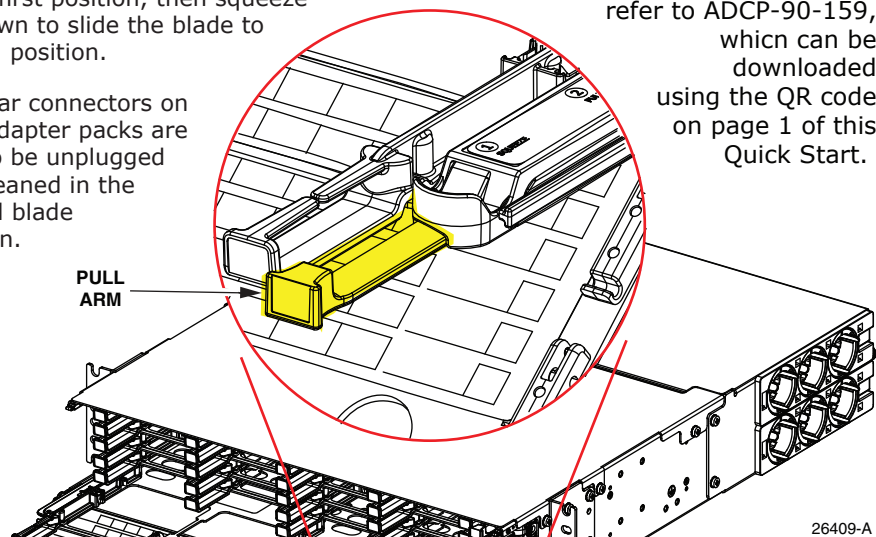

**Danger:**

Infrared radiation is invisible and can seriously damage the retina of the eye. Do not look into the ends of any optical fiber. Do not look directly into the optical adapters of the adapter packs. Exposure to invisible laser radiation may result. A protective cap or hood MUST be immediately placed over any radiating adapter or optical fiber connector to avoid the potential of dangerous amounts of radiation exposure. This practice also prevents dirt particles from entering the connector and adapter.

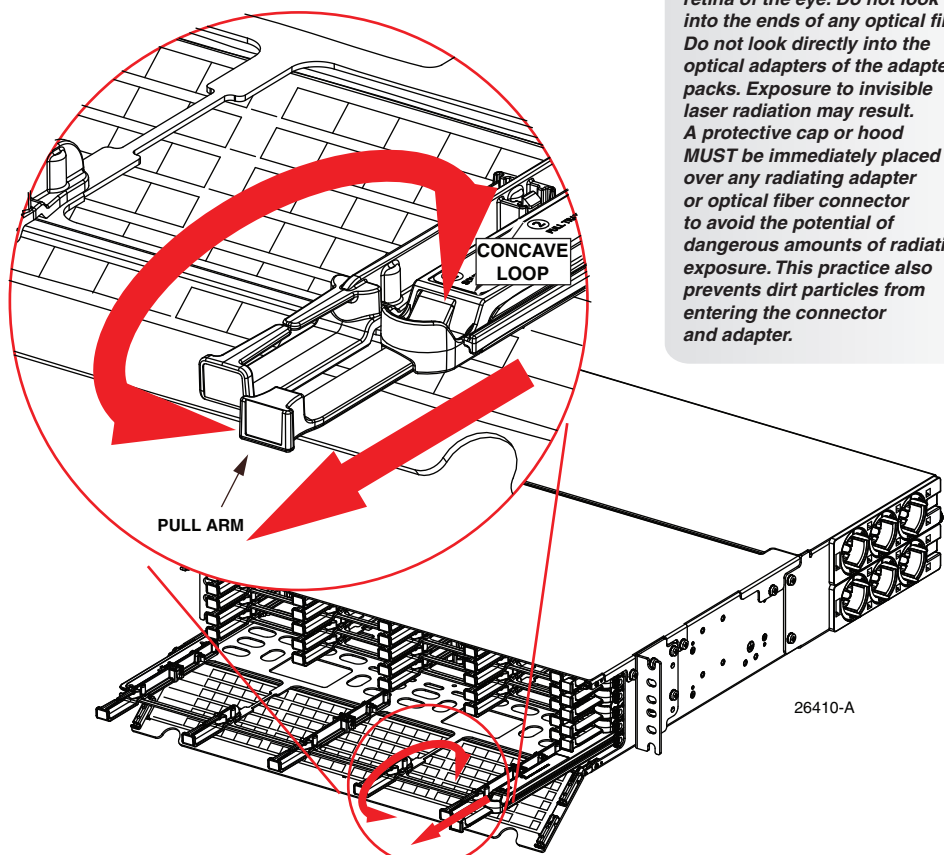

6

### Install Adapter Pack or Module

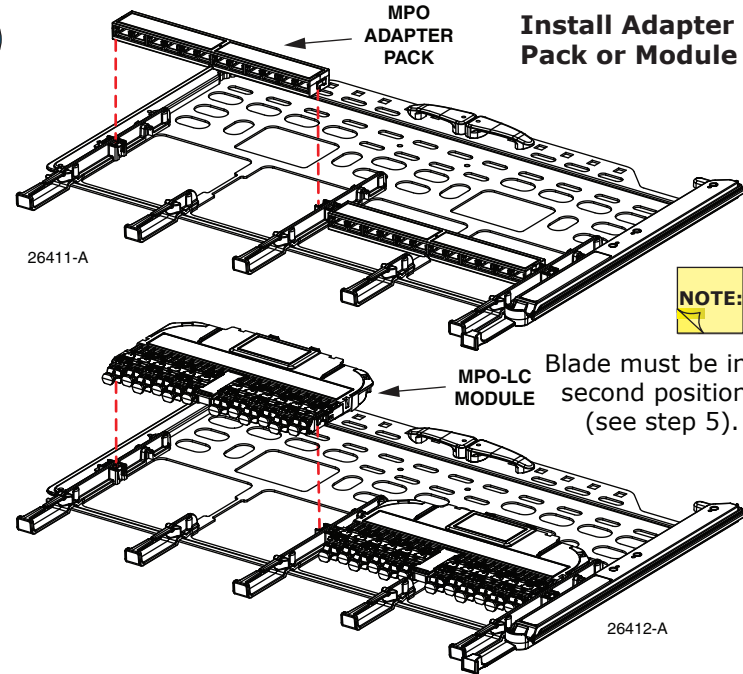

**NOTE:** Blade must be in second position (see step 5).

7

### Remove Rear Cover (if not removed in Step 2)

Turn fasteners counterclockwise to release cover and lift off.

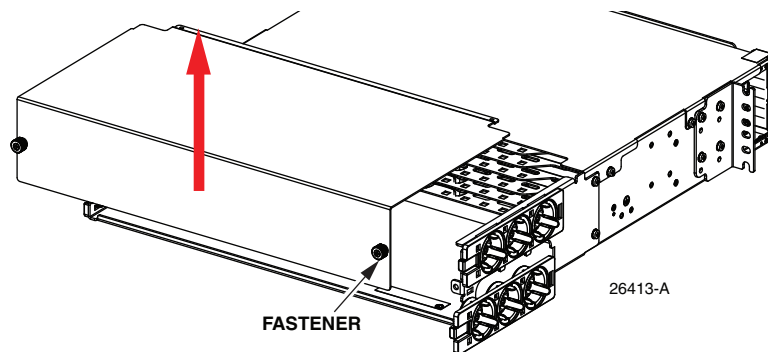

8

### Initial Panel Trunk Installation Preferred Method

Load panel from bottom up. Use farthest back trunk opening first working forward then up.

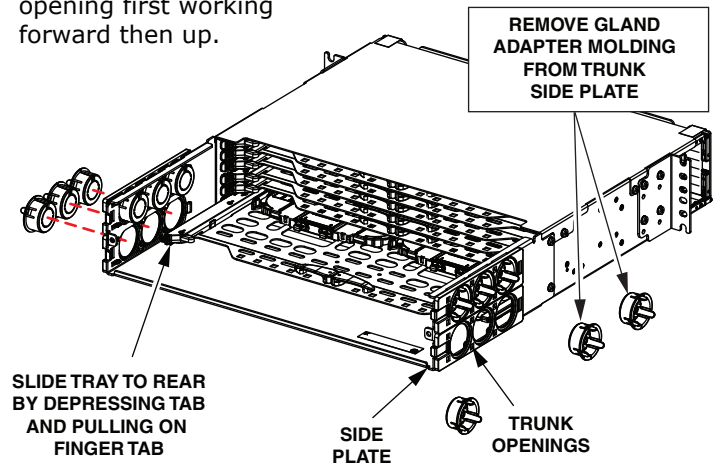

9

### Secure and Route Cable

Remove center "knockout" from gland adapter molding. Slide over cable through slit on side. Before securing cable to rack or bracket outside of panel make sure there is 30-33 in. (76.2-83.82cm) slack in cable for proper blade movement. Using a CommScope trunk with gland adapter shown below will usually provide this slack. Dress breakouts with "Hook and Loop." For non-CommScope trunks, include a piece inside of the molding.

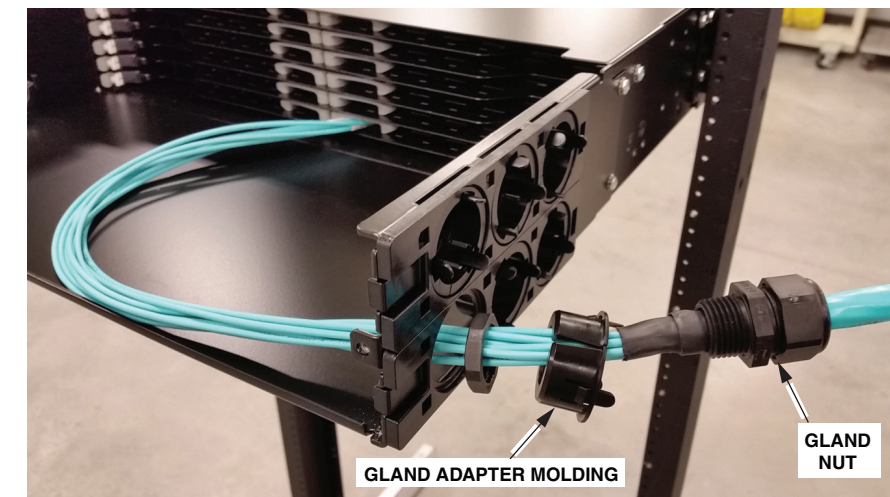

10

### Route Patch Cords

When connecting patch cords, route patch cords from the center of the EHD outward to each side, using the cable guides to secure and route the patch cords as shown below.



11

### Close Back Cover and Front Door

26401-D

COMMSCOPE®

PRODUCT PATENTS: <http://www.commscope.com/ProductPatent/ProductPatent.aspx>  
 PRODUCT INFORMATION AND TECHNICAL SUPPORT: <http://www.commscope.com/SupportCenter>