

## 860665492-AMK-008-INSTALL INSTALLATION INSTRUCTION

DBHP RADIO ENCLOSURE - ERICSSON VERSION

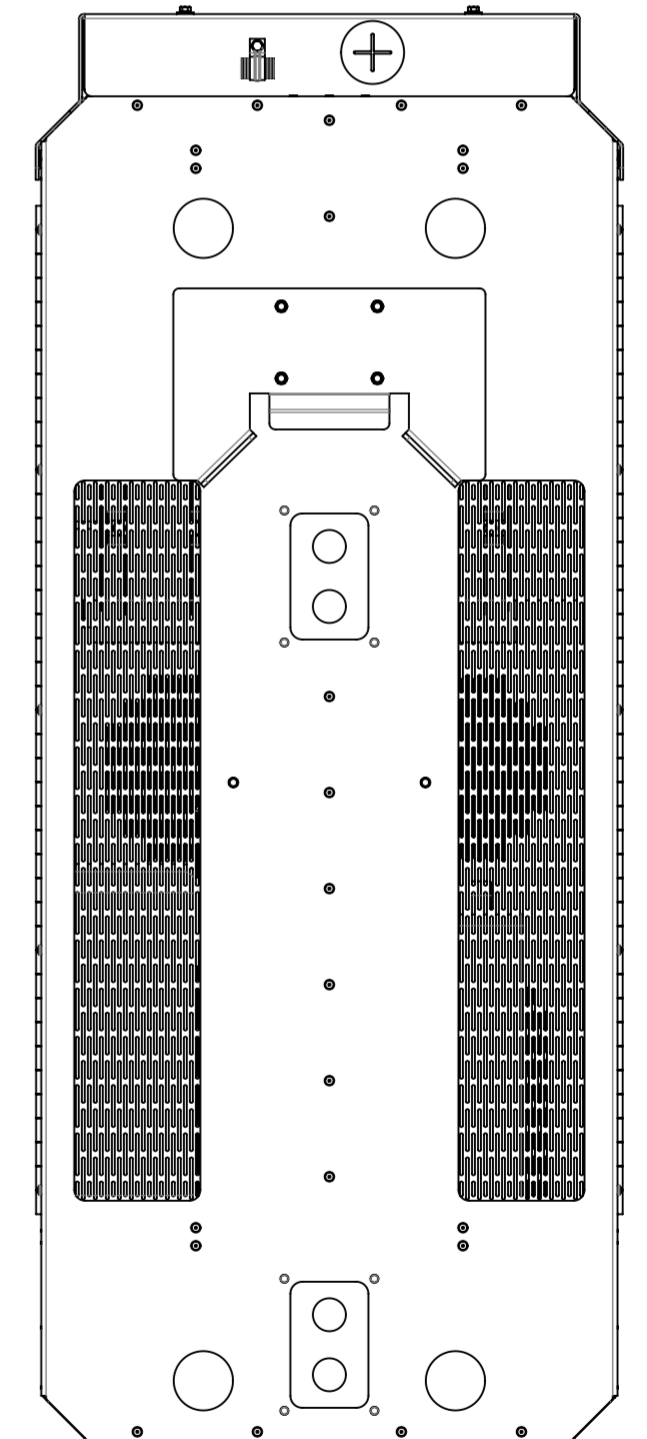
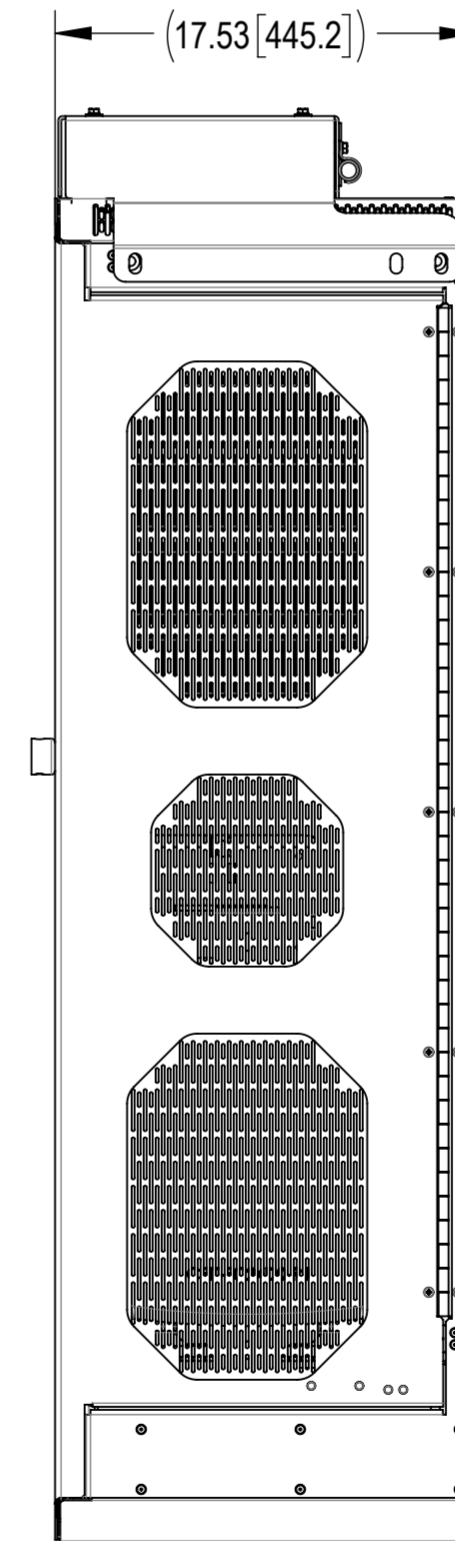
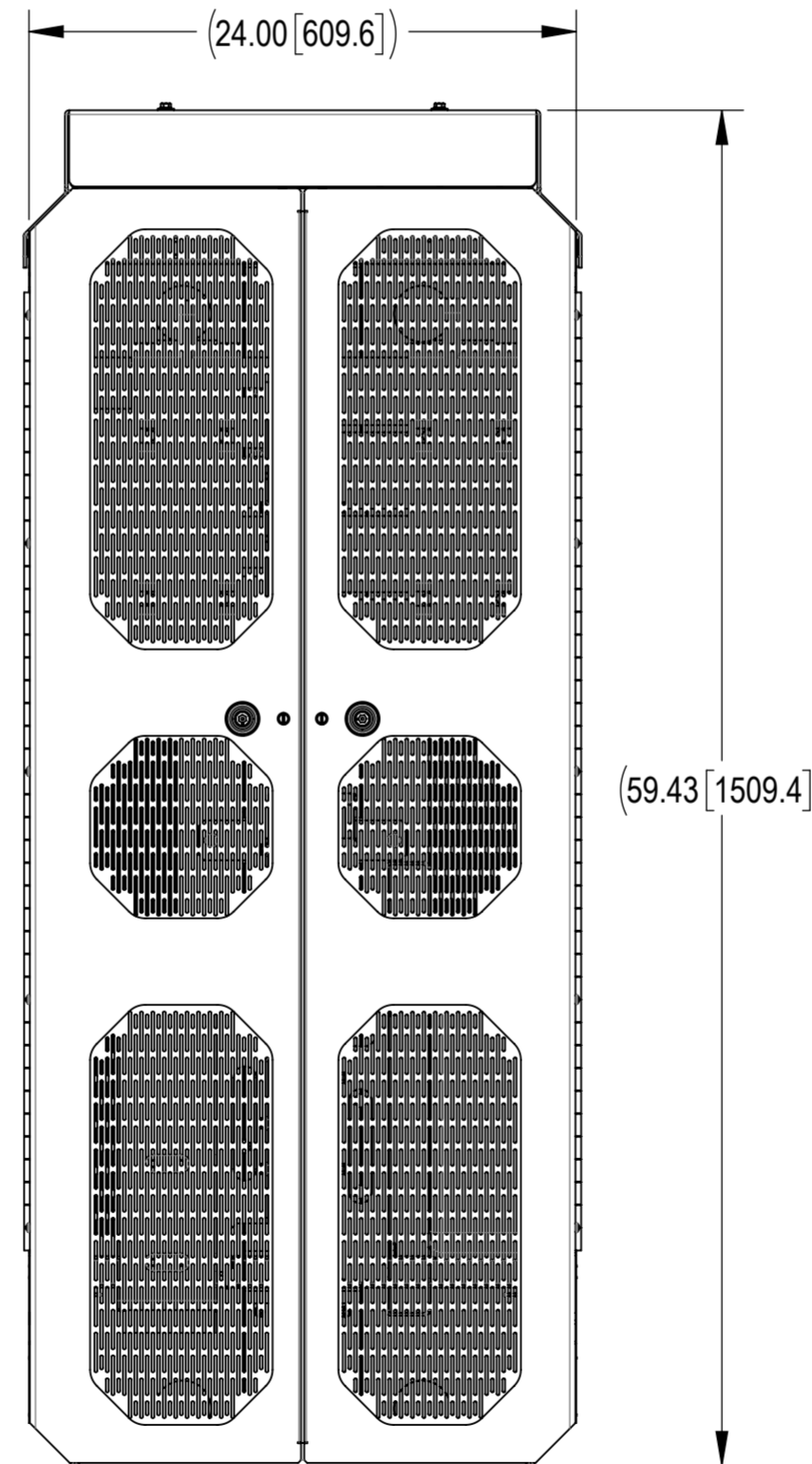
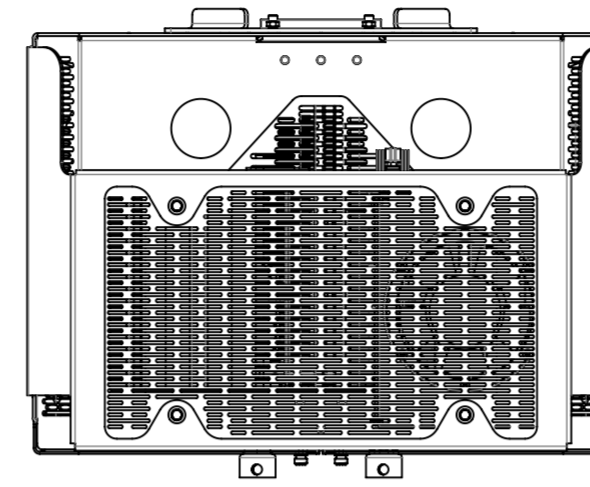
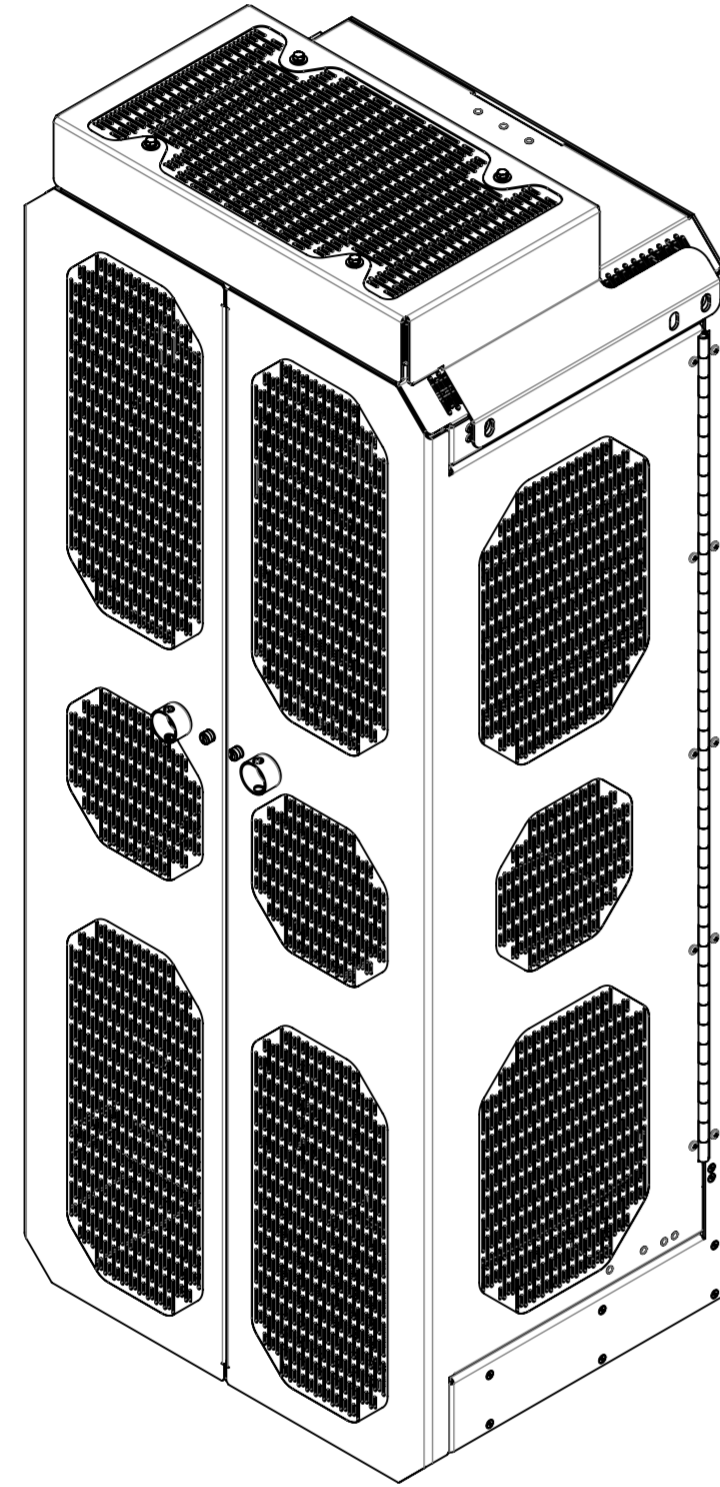

REVISIONS			
REV.	DESCRIPTION	DATE	APPROVED
A	INITIAL RELEASE	NSUN 21JUN24	JX1002 40198601CMO
B	ADDED 860665492-AMK-006 FOR RADIO TABLE ON SHEET 2 AND ADDED NOTE 3.6; UPDATED RADIO TABLE	NSUN 12JUL24	JX1002 40199231CMO

This table show the evolution and history of document from initial to current version.

Further information regarding CommScope's commitment can be found at [www.commscope.com/About-Us/Corporate-Responsibility-and-Sustainability](http://www.commscope.com/About-Us/Corporate-Responsibility-and-Sustainability). Visit our website or contact your local CommScope representative for more information. This product is covered by one or more U.S. patents or their foreign equivalents. For patents, see [www.commscope.com/ProductPatent/ProductPatent.aspx](http://www.commscope.com/ProductPatent/ProductPatent.aspx)

# Installation Instructions



- 1.0 GENERAL NOTES
  - 1.1 ALL METRIC DIMENSIONS ARE IN BRACKETS [X.X]
- 2.0 DESIGN NOTES
- 3.0 MANUFACTURING/SPECIAL REQUIREMENTS
  - 3.1 TIGHTEN HARDWARES, TORQUE VALUE ARE SHOWN BELOW AS REFERENCE,
    - M6: TORQUE 40.0 IN-LB OR 4.5 N-M (W/ CLIP NUT)
    - M6: TORQUE 46.0 IN-LB OR 5.2 N-M (W/ THREADED CAST AL)
    - M6: TORQUE 75.0 IN-LB OR 8.5 N-M (W/ STEEL NUT)
    - M8: TORQUE 6.6 FT-LB OR 9.0 N-M (W/ THREADED CAST AL)
    - 1/4-20: TORQUE 4.8 FT-LB OR 6.6 N-M
    - 3/8-16: TORQUE 19.6 FT-LB OR 26.6 N-M
  - 3.2 CONFIGURATIONS AND QUANTITY OF EQUIPMENTS IN INSTALLATION ARE LISTED ON TABLE.
  - 3.3 EQUIPMENT INSTALLATION INSTRUCTION ON PAGE 3.
  - 3.4 "X" IS A VARIABLE FOR COLOR, KIT SHOULD BE COLOR MATCHED TO ENCLOSURE DEPLOYED ON SITE.
  - 3.5 IF THE MOUNTING HOLES DO NOT MATCH, FIELD FABRICATION WORK WILL BE REQUIRED TO RELOCATE IT.
  - 3.6 THE BRACKET IS INCLUDED IN 860665492-AMK-006

ERICSSON CONFIGURATION	3.2 APPROVED ERICSSON RADIO CONFIGURATIONS							REQUIRED ADDITIONAL AMK FOR CONFIGURATION (PURCHASED SEPARATELY)	
	8843	4449	4490	4890	220x or 440x	PSU 6308	FIBER PATCH PANEL CFIT-FC24D0-RJ	860665492-AMK-006	3.4 860661736-MV2-C03X
1	1	1			1	1	1	1	1
2	1		1		1	1	1	1	1
3		1		1	1	1	1	1	1
4			1	1	1	1	1	1	1

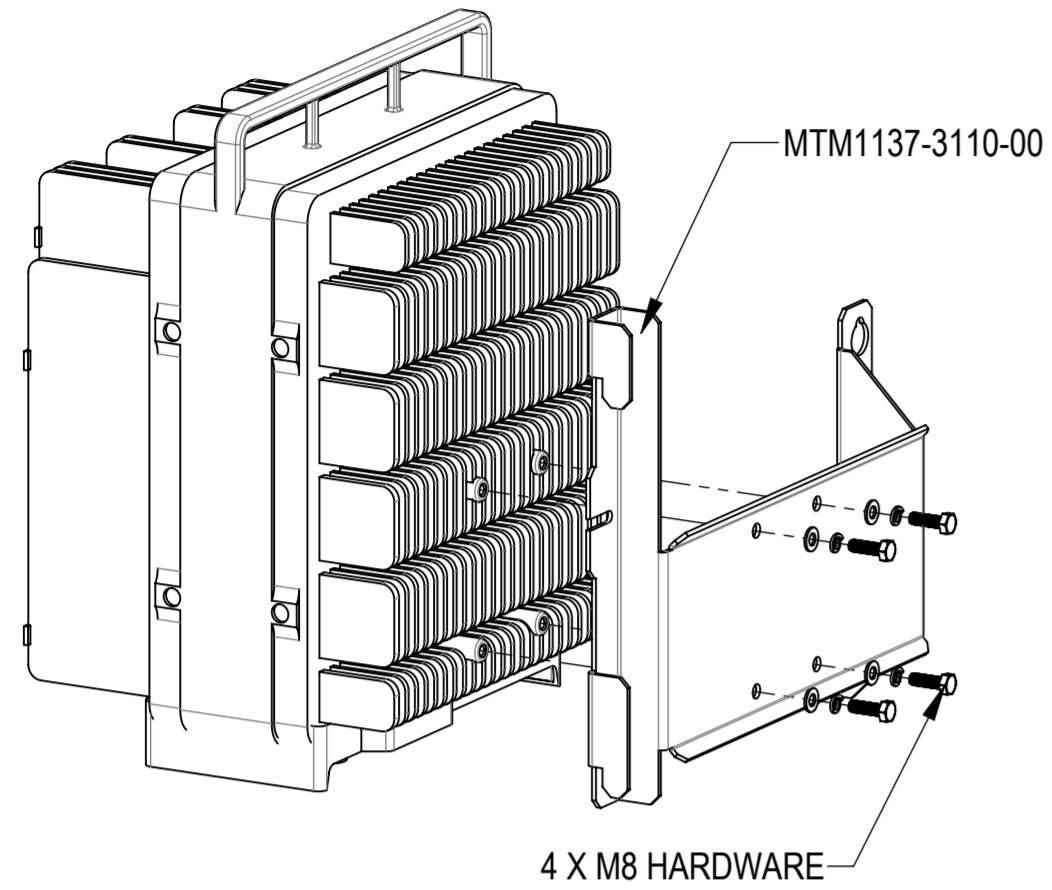

### 8843:

INSTALL 8843 TO THE BRACKET MTM1137-3110-00 USING 4 SETS OF M8 HEX BOLT, LOCK WASHER AND FLAT WASHER AS SHOWN

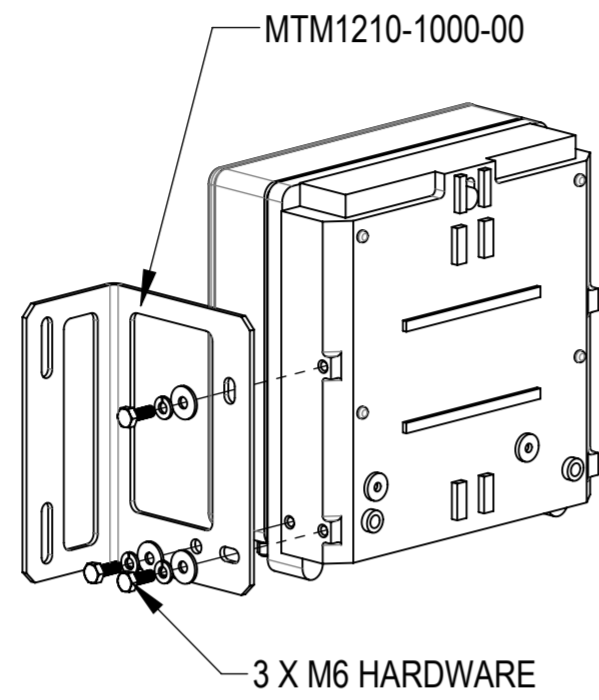

### 220x or 440x:

INSTALL 220x or 440x TO THE BRACKET MTM1210-1000-00 USING 3 SETS OF M6 HEX BOLT, LOCK WASHER AND FLAT WASHER AS SHOWN

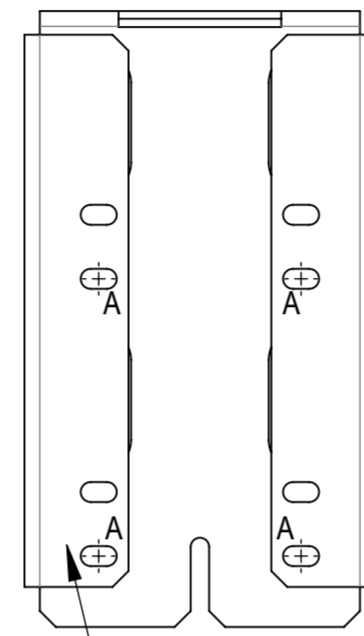

### 3.6 MTM1137-3114-00

"A": 4490 4890

### 4490:

INSTALL 4490 TO THE BRACKET MTM1137-3114-00 USING 4 SETS OF M8 HEX BOLT, LOCK WASHER AND FLAT WASHER AS SHOWN

### 4890:

INSTALL 4890 TO THE BRACKET MTM1137-3114-00 USING 4 SETS OF M8 HEX BOLT, LOCK WASHER AND FLAT WASHER AS SHOWN

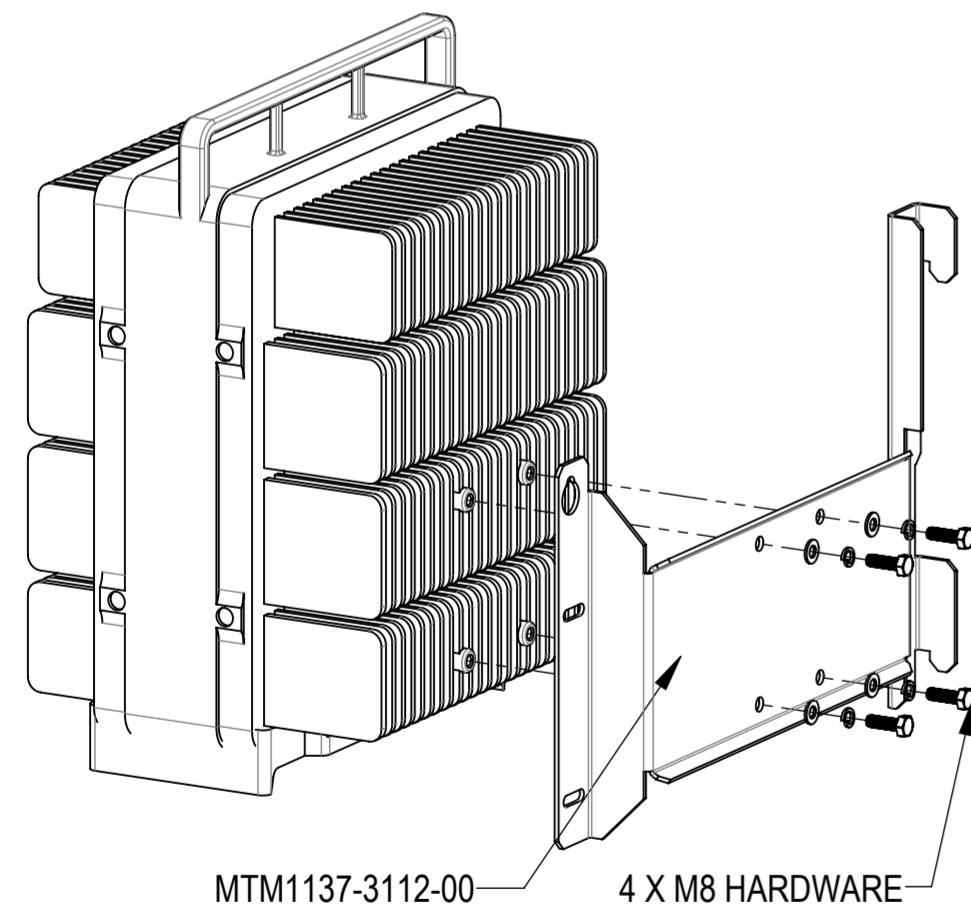

### 4449:

INSTALL 4449 TO THE BRACKET MTM1137-3112-00 USING 4 SETS OF M8 HEX BOLT, LOCK WASHER AND FLAT WASHER AS SHOWN

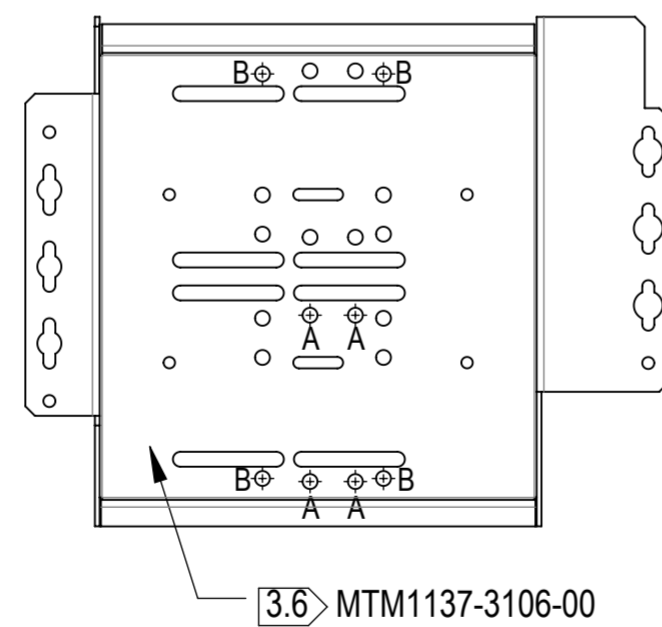

"A": 6308  
"B": CFIT-FC24D0-RJ

### 6308:

INSTALL 6308 TO THE BRACKET MTM1137-3106-00 USING 4 SETS OF M8 HEX BOLT, LOCK WASHER AND FLAT WASHER AS SHOWN

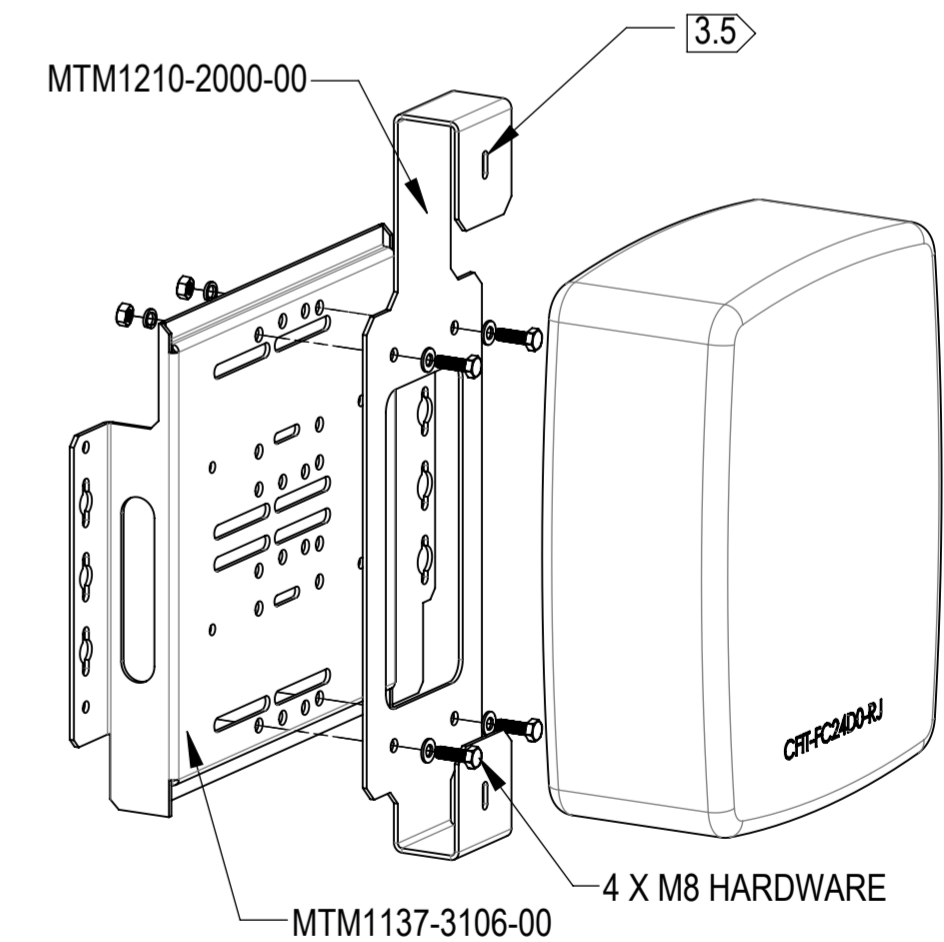

### CFIT-FC24D0-RJ:

INSTALL THE BRACKET MTM1210-2000-00 TO THE BRACKET MTM1137-3106-00 USING 4 SETS OF M8 HEX BOLT, LOCK WASHER AND FLAT WASHER AS SHOWN

INSTALL CFIT-FC24D0-RJ TO THE COMBO BRACKET USING 2 SETS OF CUSTOMER PROVIDED HARDWARE

## HARDWARE INSTALLATION

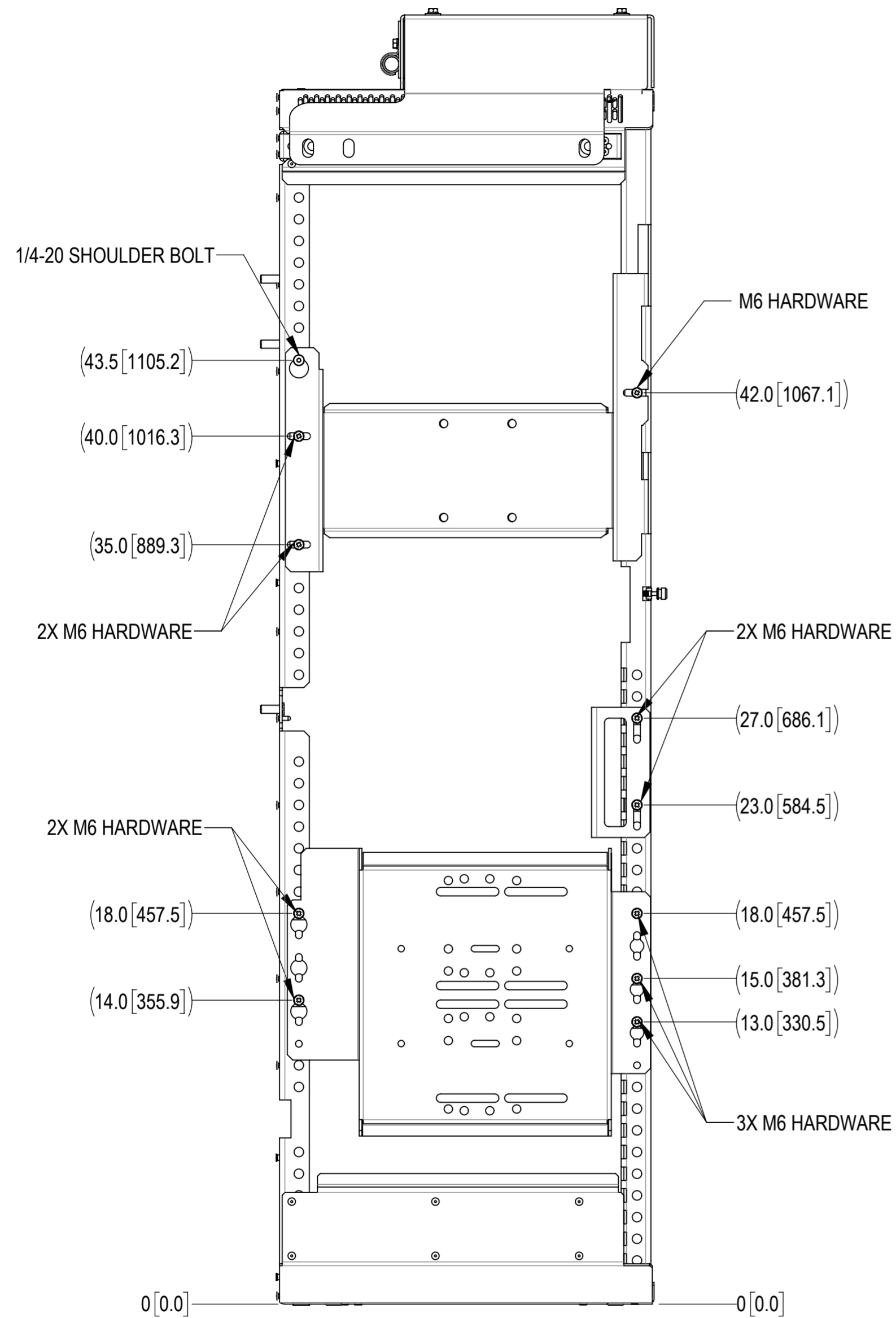

LEFT SIDE VIEW  
(BRACKET SHOWN FOR REFERENCE)  
(EQUIPMENT NOT SHOWN)

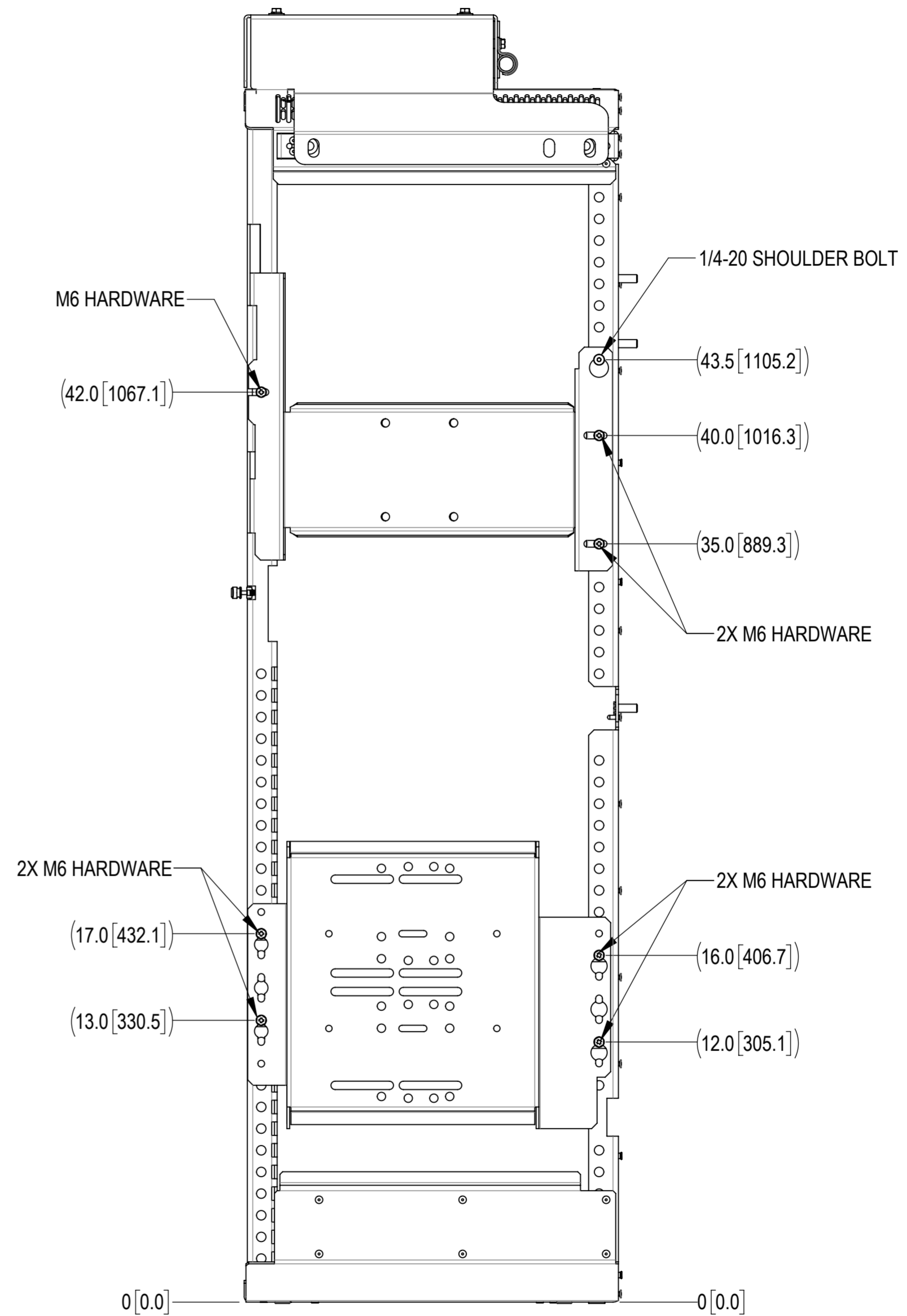

RIGHT SIDE VIEW  
(BRACKET SHOWN FOR REFERENCE)  
(EQUIPMENT NOT SHOWN)

## C1- 8843 & 4449 & 220x/440x & CFIT-FC24D0-RJ AND 6308

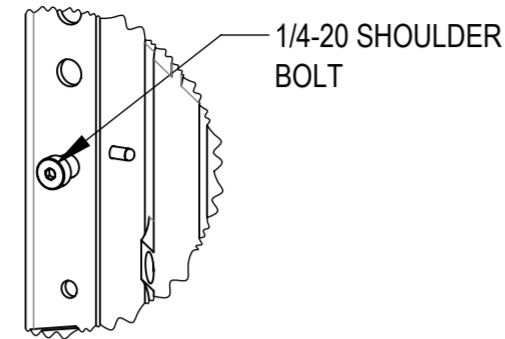

DETAIL A  
SCALE 1 : 3

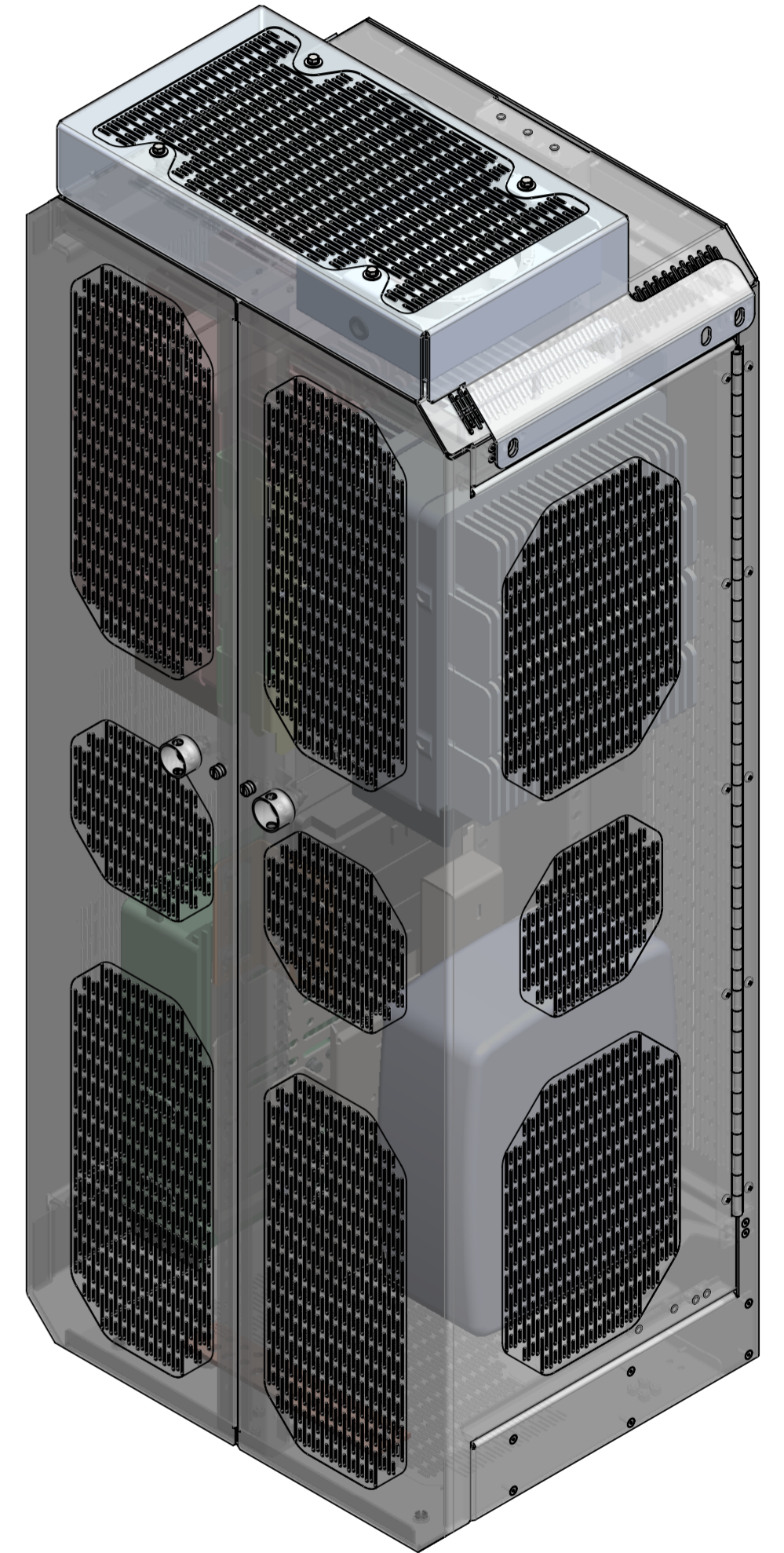
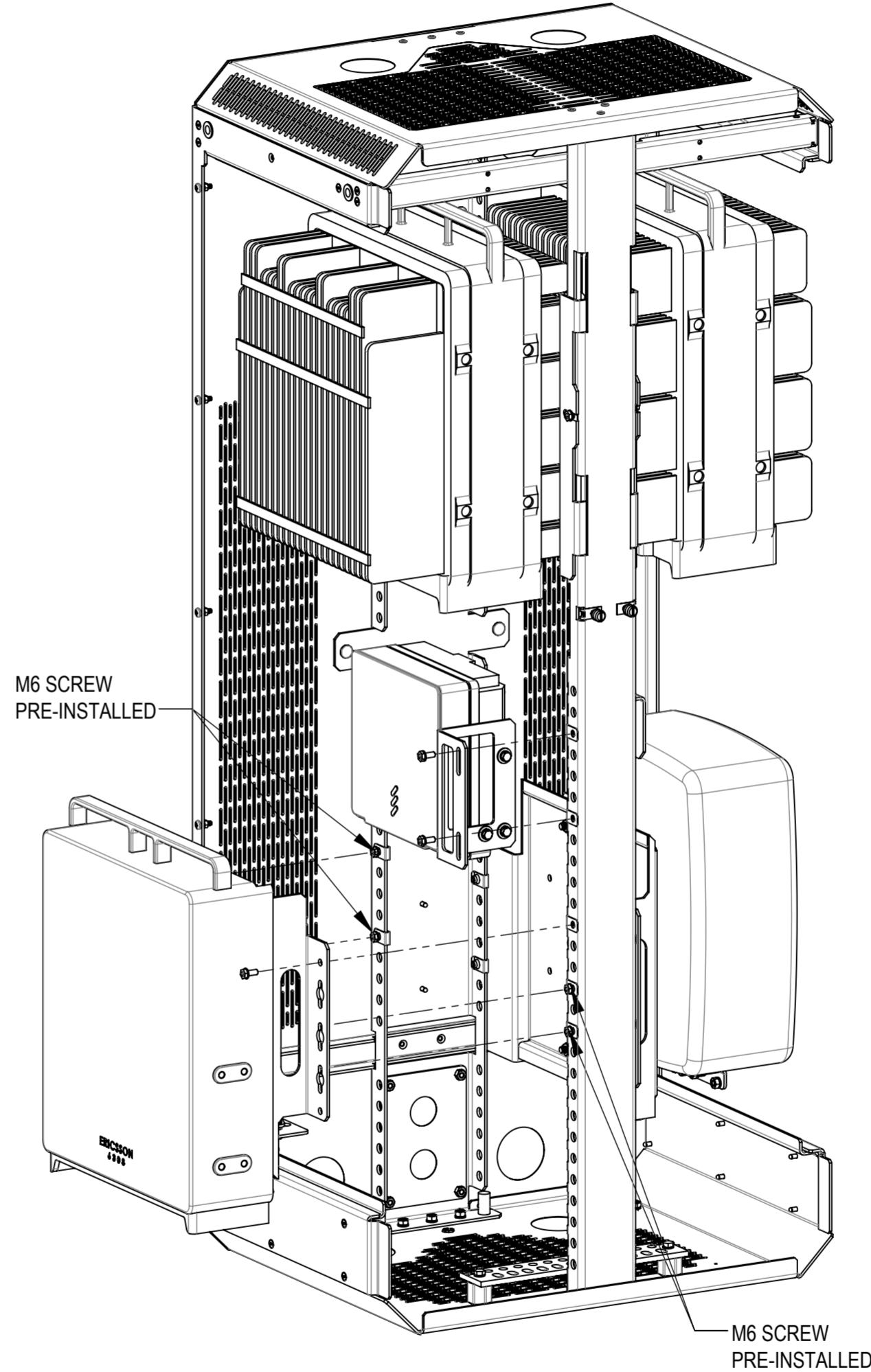
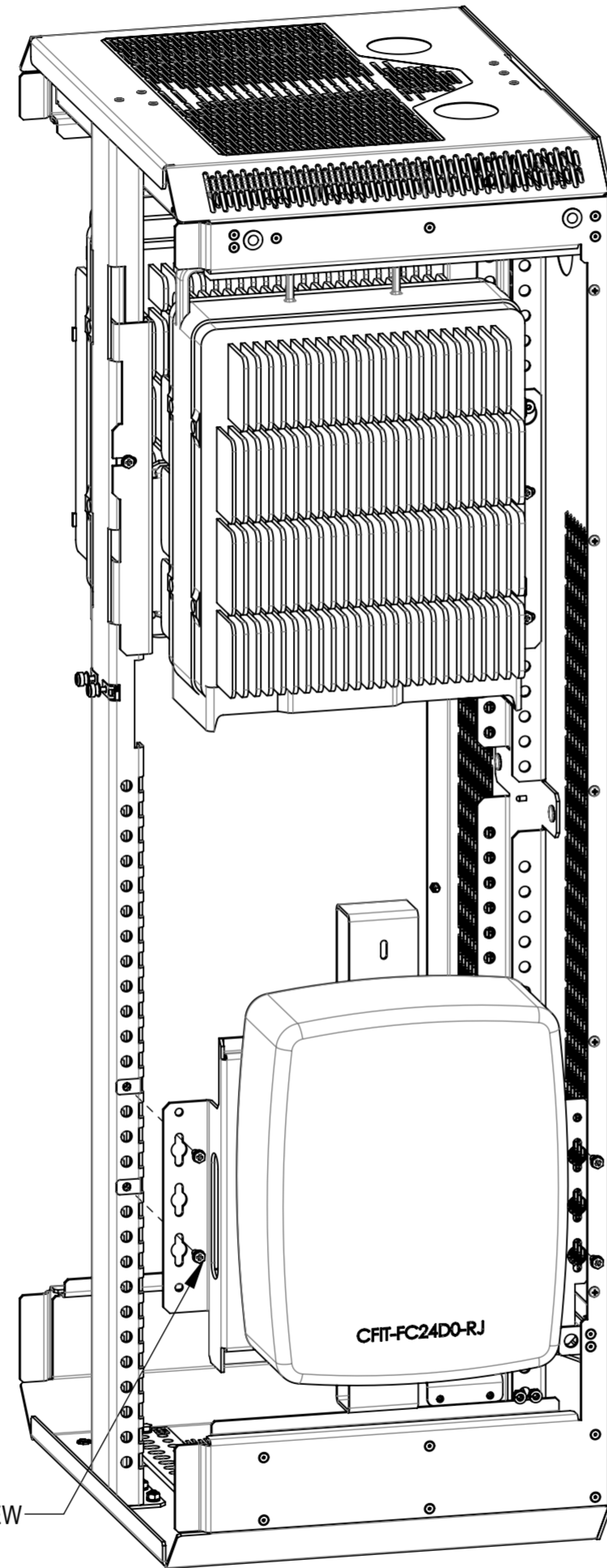
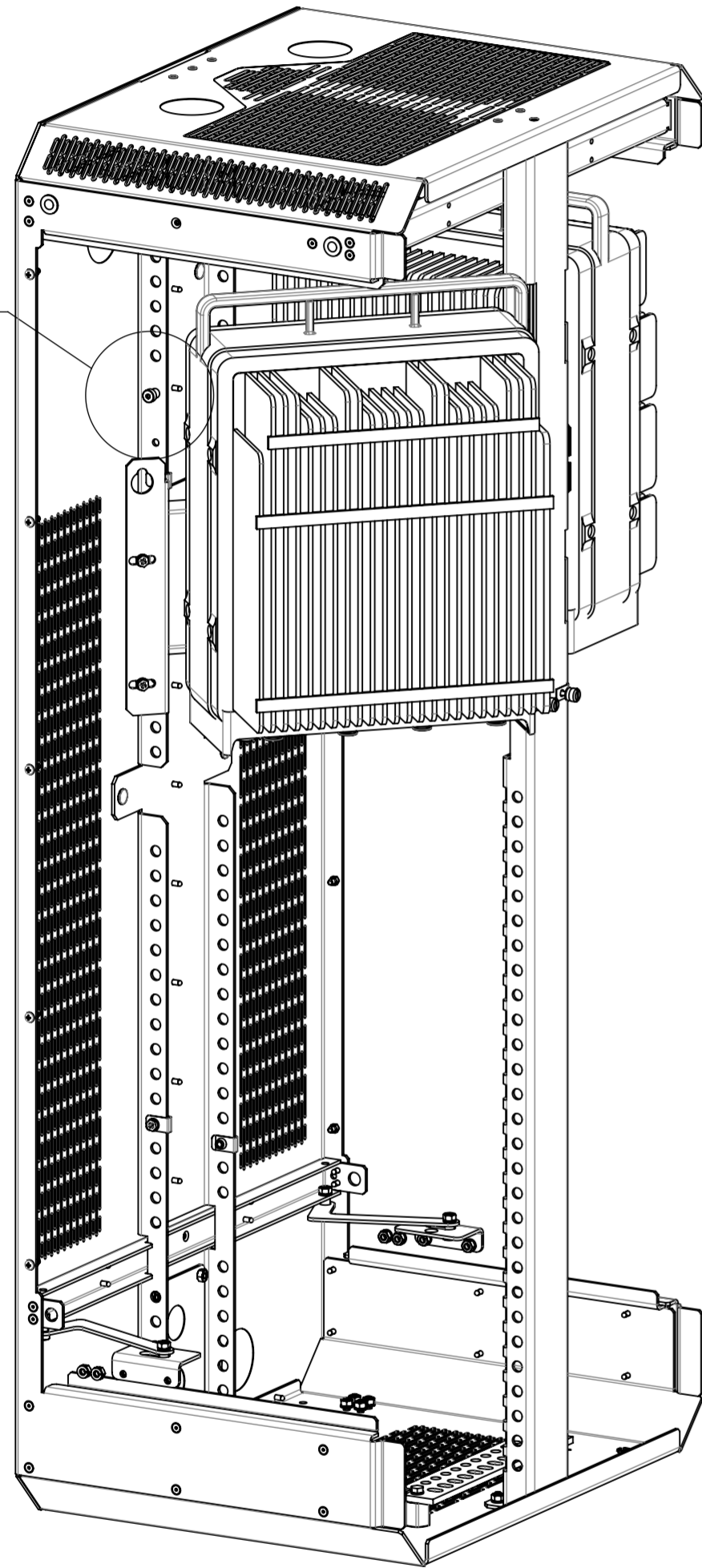

### 8843 (LEFT) INSTALLATION: 4449 (RIGHT) INSTALLATION:

- A) INSTALL SHOULDER BOLT IN TOP LOCATION AS SHOWN(SEE SHEET 4)
- B) HOLD RRU PANEL BETWEEN 45-90 DEG. AND INSERT BOTH TABS INTO SLOT ON UPRIGHT
- C) ROTATE PANEL INTO PLACE AND LIFT ONTO THE REAR UPRIGHT GUIDING PIN FOR SUPPORT
- D) SECURE PANEL WITH PROVIDED M6 HARDWARE
- E) REPEAT PROCESS FOR OPPOSITE SIDE RRU MOUNTING(IF APPLICABLE)

### CFIT-FC24D0-RJ INSTALLATION:

INSTALL CFIT-FC24D0-RJ WITH BRACKET ON ENCLOSURE AND SECURE BY 4 SETS OF M6 SCREW AND CLIP NUT

### 220x or 440x INSTALLATION: 6308 INSTALLATION:

INSTALL 220x or 440x WITH BRACKET ON ENCLOSURE AND SECURE BY 2 SETS OF M6 SCREW AND CLIP NUT

INSTALL 6308 WITH BRACKET ON ENCLOSURE AND SECURE BY 5 SETS OF M6 SCREW AND CLIP NUT

### FAN KITS INSTALLATION:

INSTALL THE FAN KIT 860661736-MV2-C03X TO THE TOP OF DBHP, SEE 860661736-MV2-C03-INSTALL

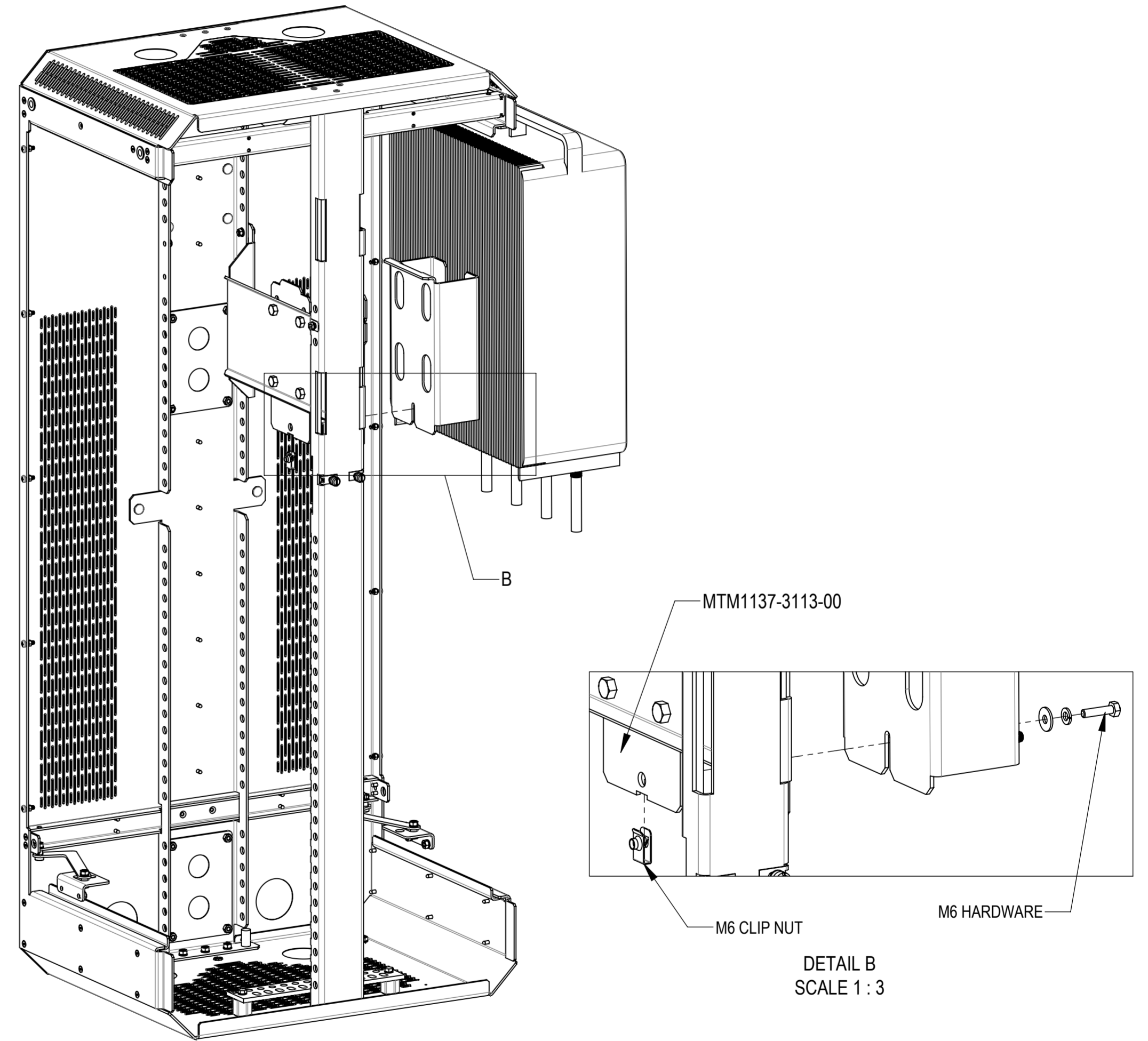
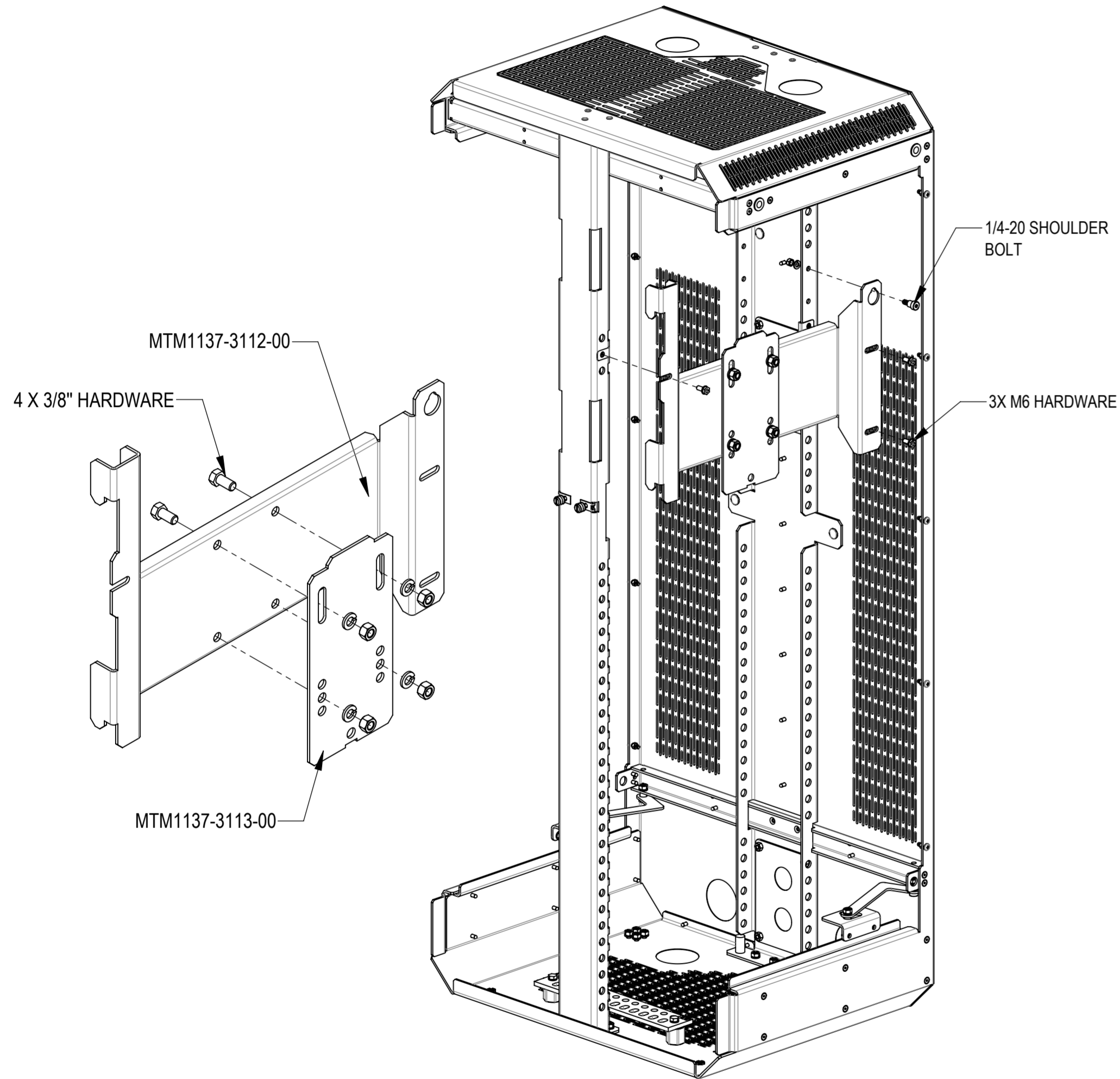

### MTM1137-3112-00 & MTM1137-3113-00 (RIGHT):

- A) INSTALL MTM1137-3113-00 TO THE EQUIPMENT MOUNT BRACKETS MTM1137-3112-00 AND SECURE USING 4 SETS OF 3/8" HEX BOLT, LOCK WASHER AND NUT
- B) SECURE THE COMBO BRACKET USING 4 SETS OF M6 HEX BOLT, LOCK WASHER, FLAT WASHER, CLIP NUT AND 1 SETS OF 1/4 SHOULDER BOLT, LOCK WASHER, NUT

### 4490 INSTALLATION (RIGHT):

HANG 4490 WITH BRACKET ON MOUNT BRACKETS MTM1137-3113-00 AND SECURE BY 1 SETS OF M6 SCREW AND CLIP NUT

## C2- 8843 & 4490 & 220x/440x & CFIT-FC24D0-RJ AND 6308

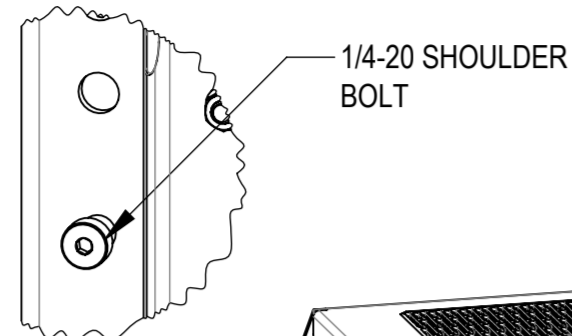

DETAIL C  
SCALE 1 : 2

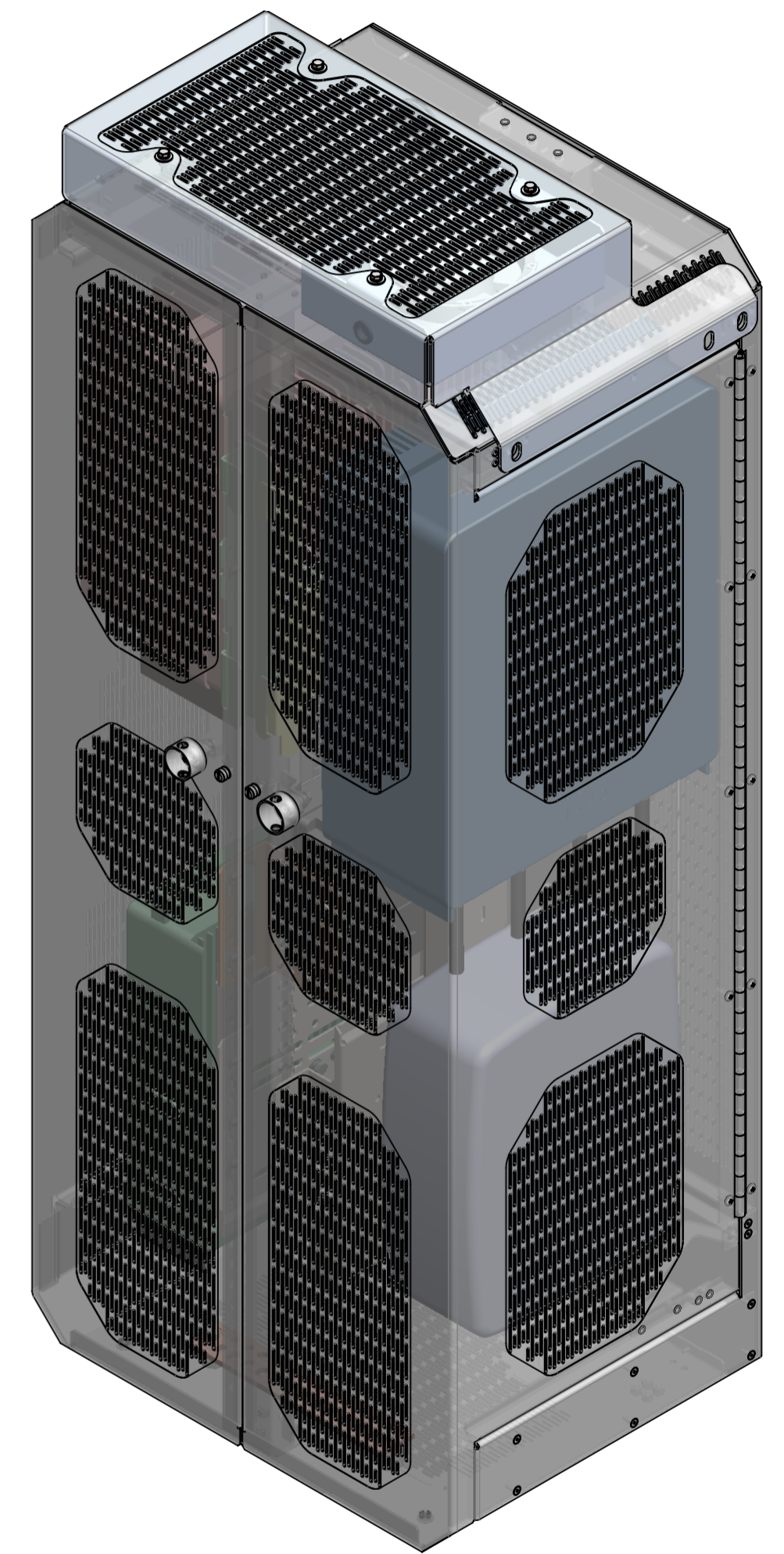
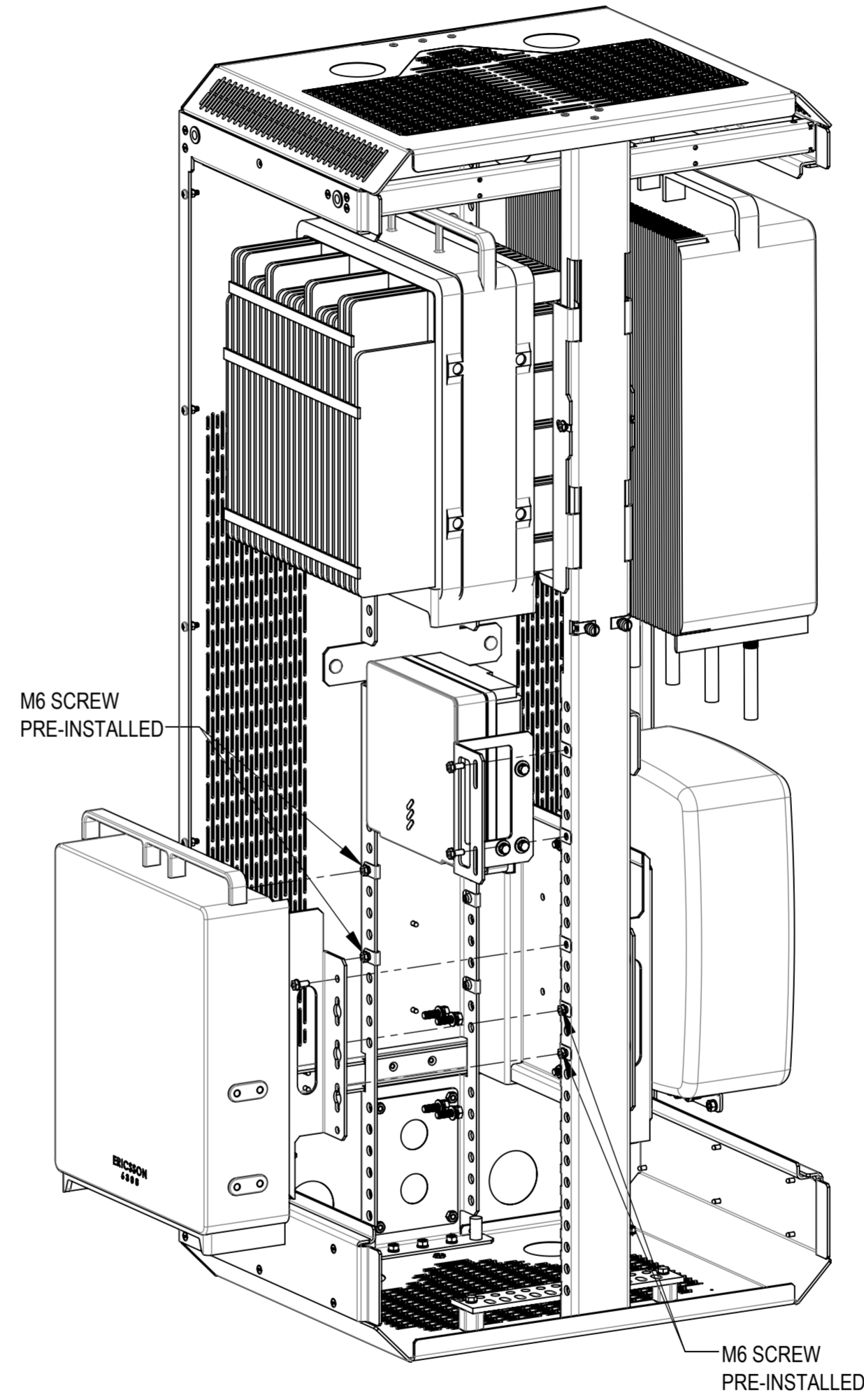
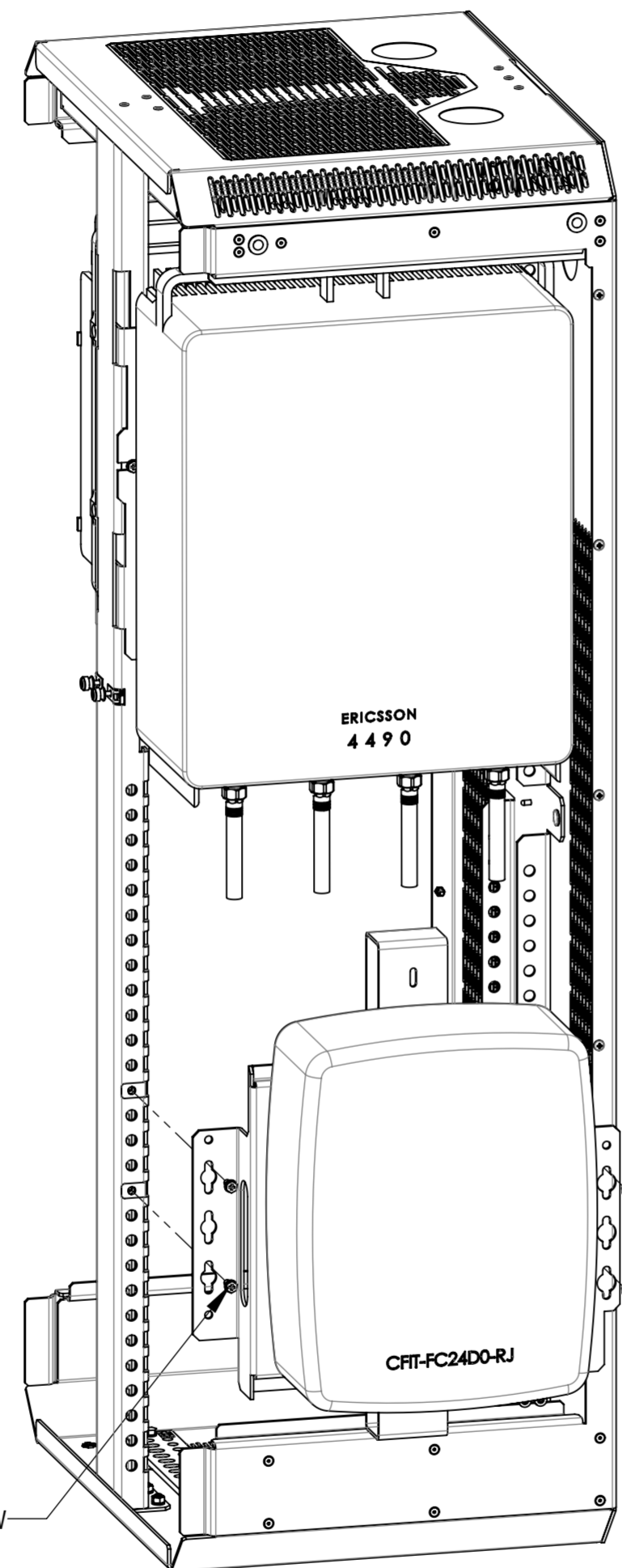
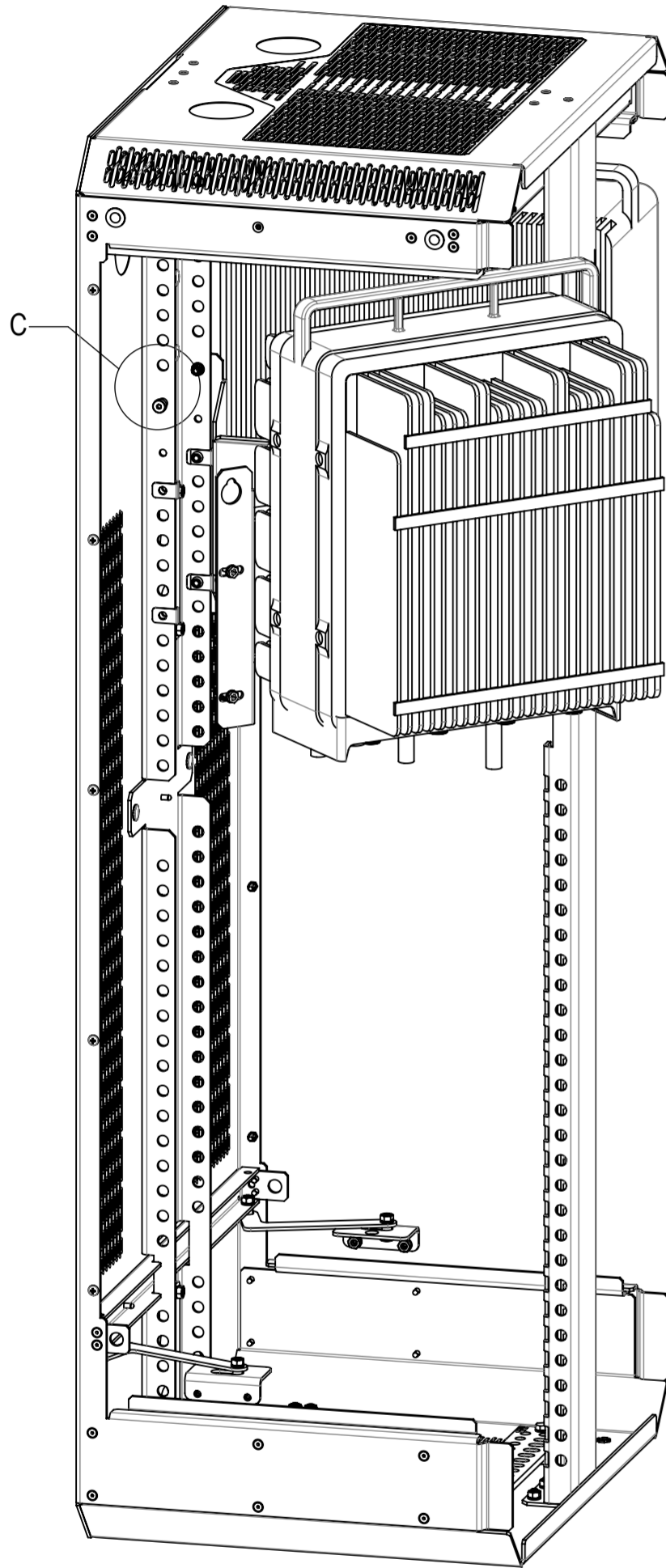

### 8843 (LEFT) INSTALLATION:

- A) INSTALL SHOULDER BOLT IN TOP LOCATION AS SHOWN(SEE SHEET 4)
- B) HOLD RRU PANEL BETWEEN 45-90 DEG. AND INSERT BOTH TABS INTO SLOT ON UPRIGHT
- C) ROTATE PANEL INTO PLACE AND LIFT ONTO THE REAR UPRIGHT GUIDING PIN FOR SUPPORT
- D) SECURE PANEL WITH PROVIDED M6 HARDWARE
- E) REPEAT PROCESS FOR OPPOSITE SIDE RRU MOUNTING(IF APPLICABLE)

### CFIT-FC24D0-RJ INSTALLATION:

INSTALL CFIT-FC24D0-RJ WITH BRACKET ON ENCLOSURE AND SECURE BY 4 SETS OF M6 SCREW AND CLIP NUT

### 220x or 440x INSTALLATION: 6308 INSTALLATION:

INSTALL 220x or 440x WITH BRACKET ON ENCLOSURE AND SECURE BY 2 SETS OF M6 SCREW AND CLIP NUT

INSTALL 6308 WITH BRACKET ON ENCLOSURE AND SECURE BY 5 SETS OF M6 SCREW AND CLIP NUT

### FAN KITS INSTALLATION:

INSTALL THE FAN KIT 860661736-MV2-C03X TO THE TOP OF DBHP, SEE 860661736-MV2-C03-INSTALL

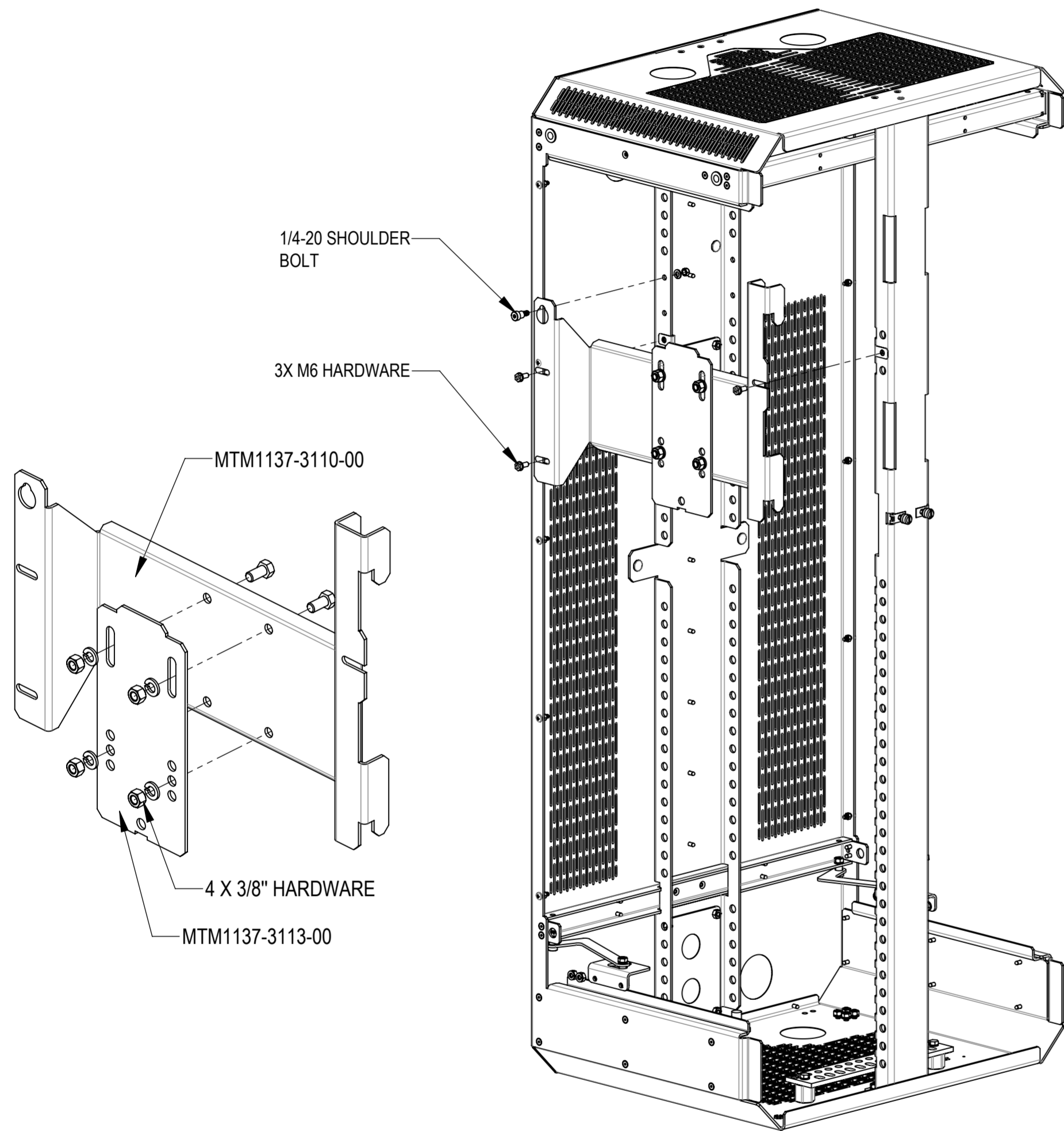

### MTM1137-3110-00 & MTM1137-3113-00 (LEFT):

- A) INSTALL MTM1137-3113-00 TO THE EQUIPMENT MOUNT BRACKETS MTM1137-3110-00 AND SECURE USING 4 SETS OF 3/8" HEX BOLT, LOCK WASHER AND NUT
- B) SECURE THE COMBO BRACKET USING 3 SETS OF M6 HEX BOLT, LOCK WASHER, FLAT WASHER, CLIP NUT AND 1 SETS OF 1/4 SHOULDER BOLT, LOCK WASHER, NUT

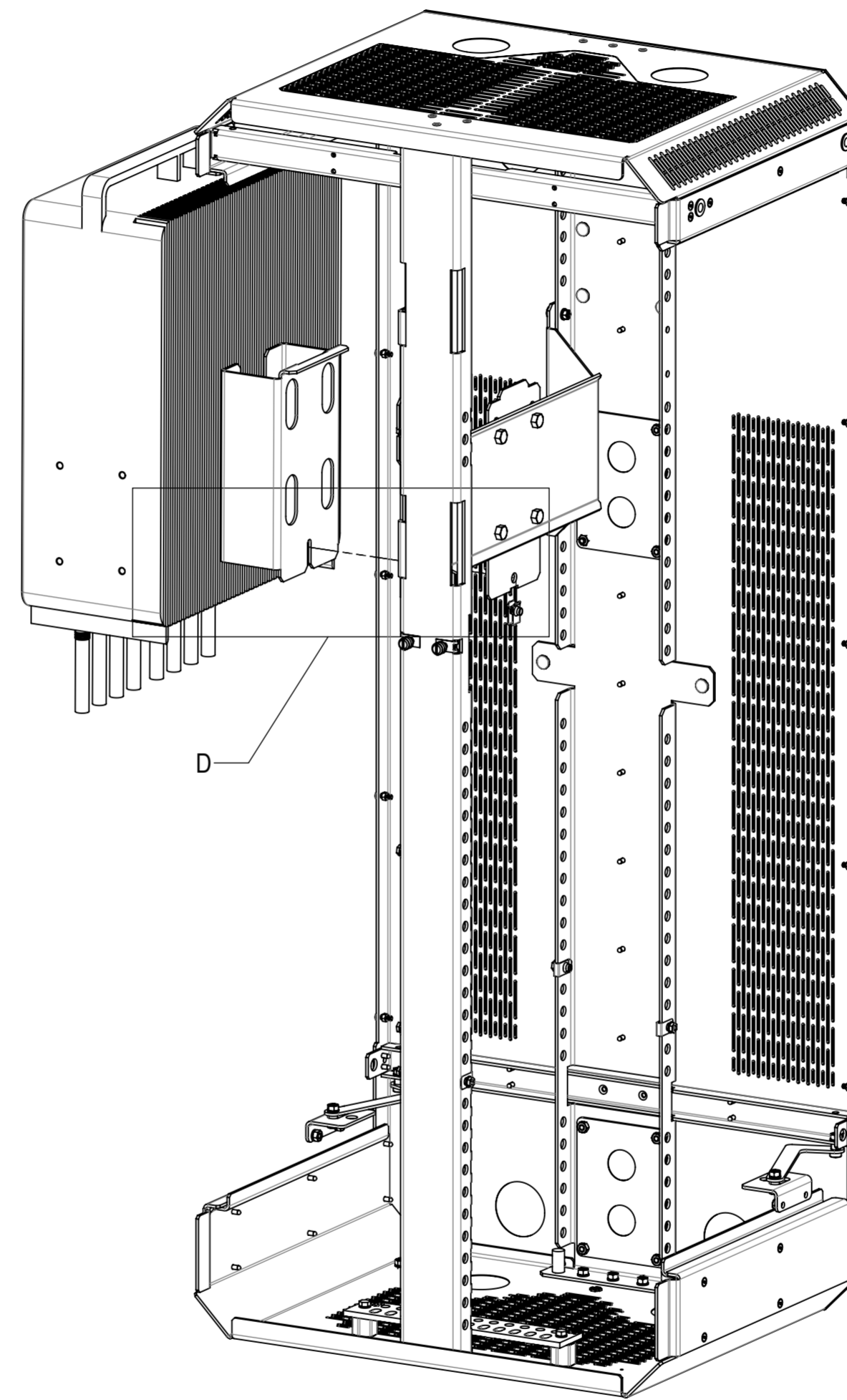

### 4890 INSTALLATION (LEFT):

HANG 4890 WITH BRACKET ON MOUNT BRACKETS MTM1137-3113-00 AND SECURE BY 1 SETS OF M6 SCREW AND CLIP NUT

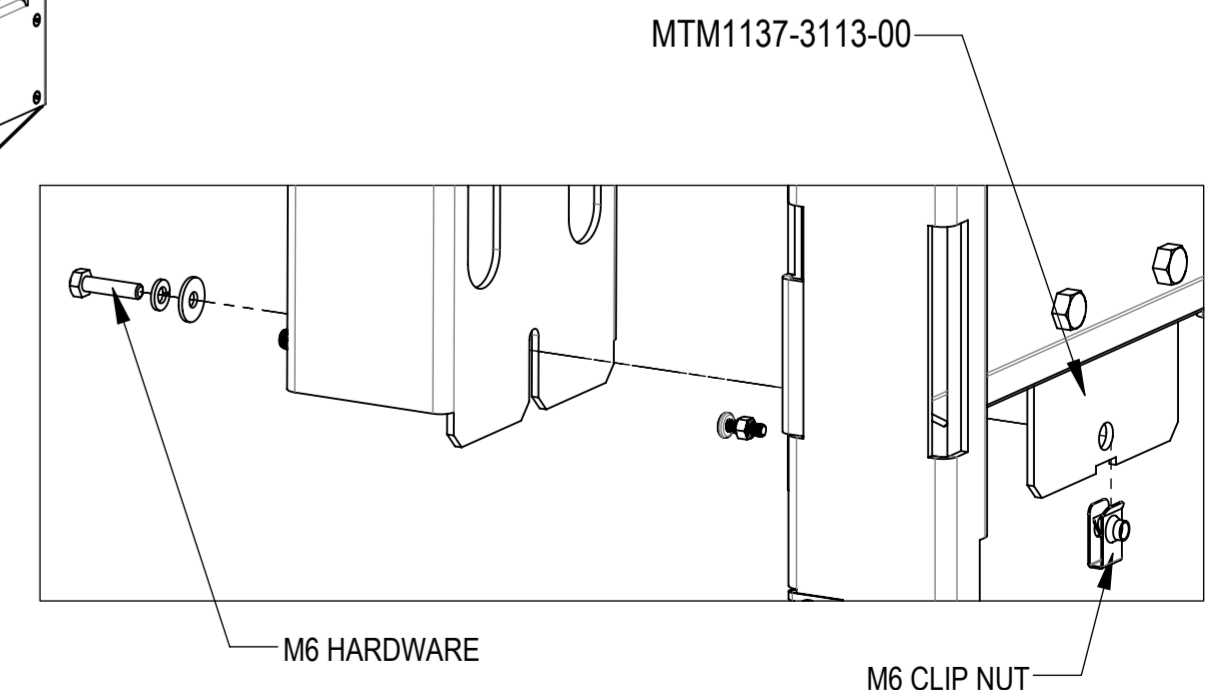

DETAIL D  
SCALE 1 : 3



# Installation Instructions

COMMScope®

## C3- 4890 & 4449 & 220x/440x & CFIT-FC24D0-RJ AND 6308

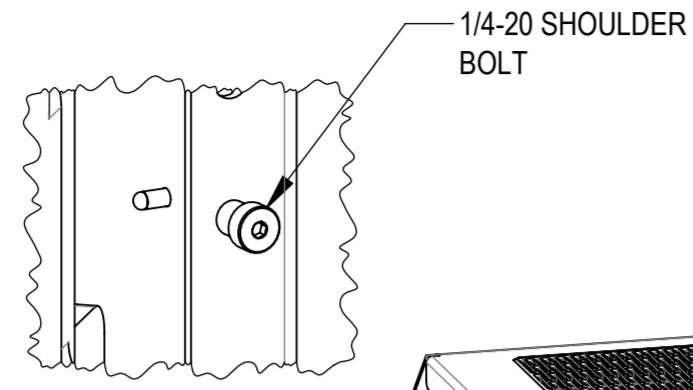

DETAIL E  
SCALE 1:2

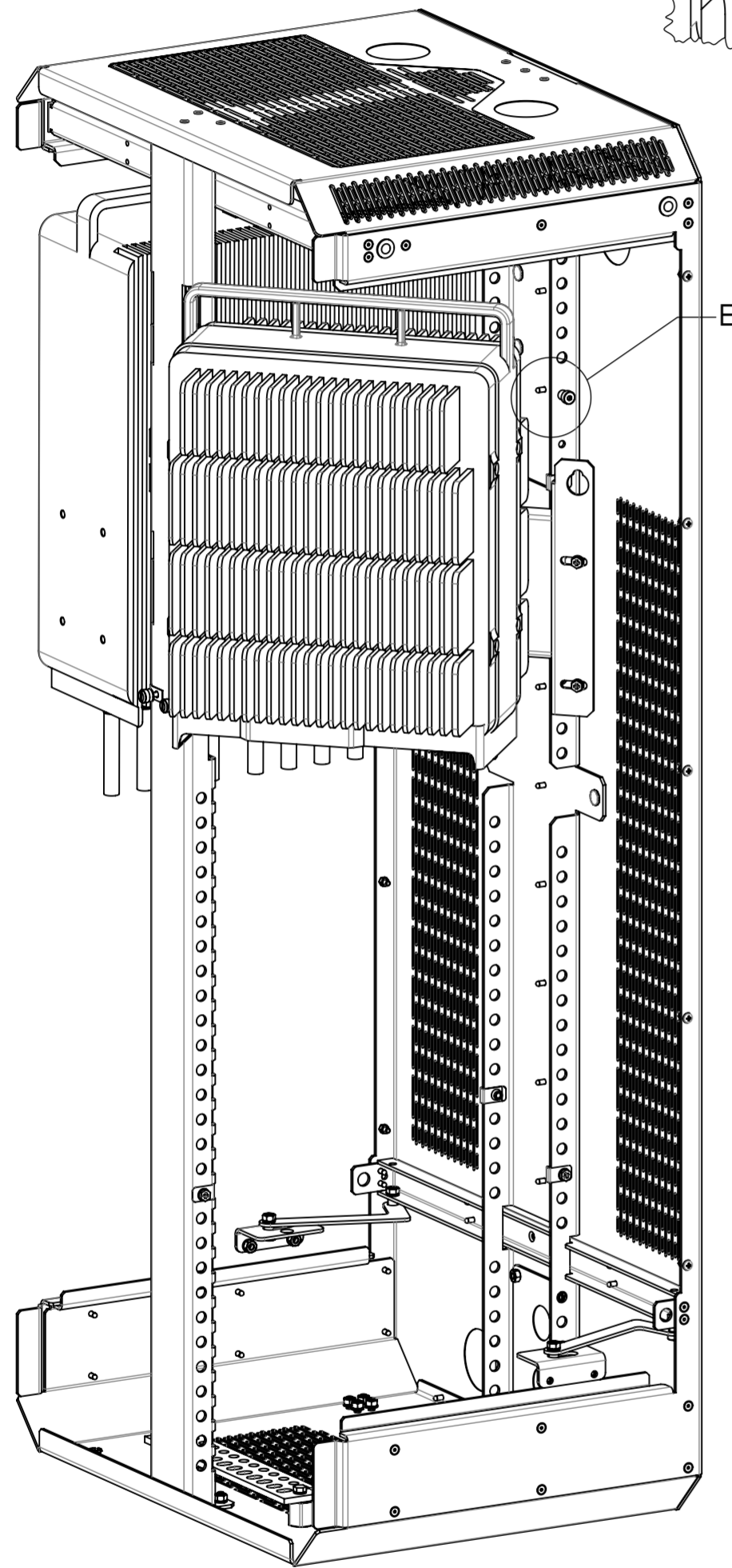

4X M6 SCREW

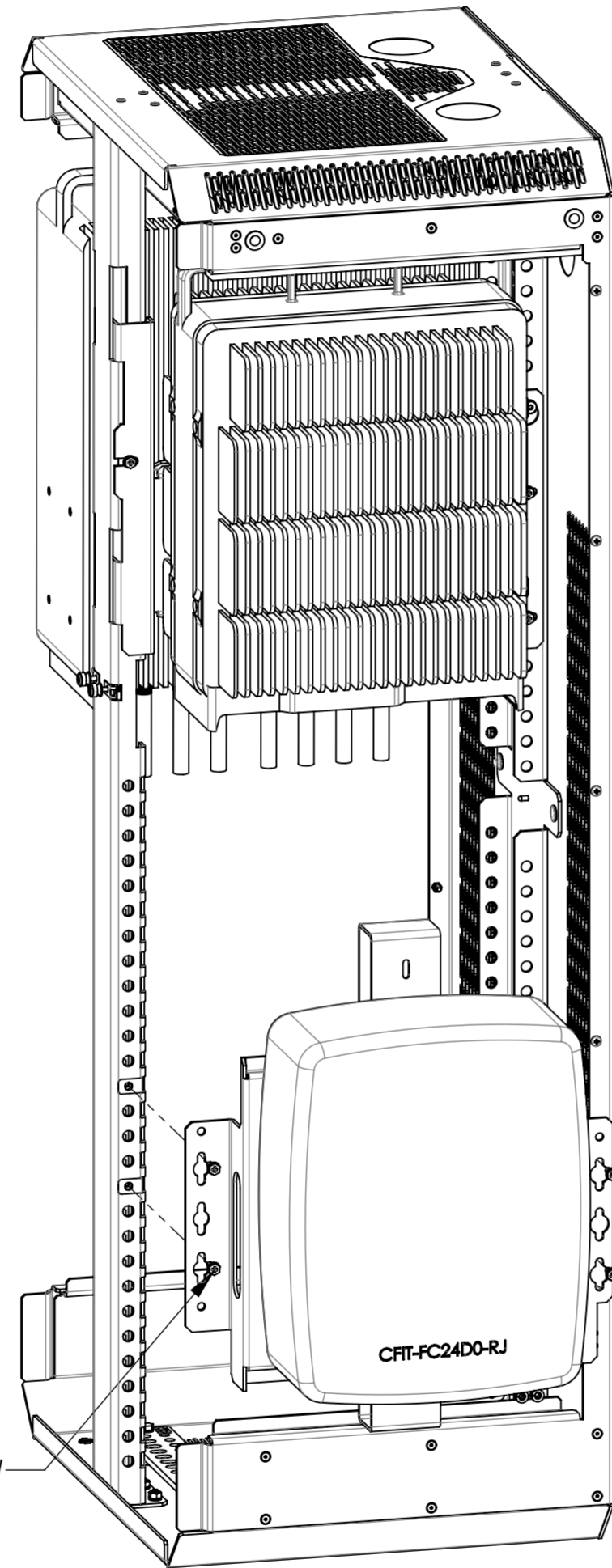

### CFIT-FC24D0-RJ INSTALLATION:

INSTALL CFIT-FC24D0-RJ WITH BRACKET ON ENCLOSURE AND SECURE BY 4 SETS OF M6 SCREW AND CLIP NUT

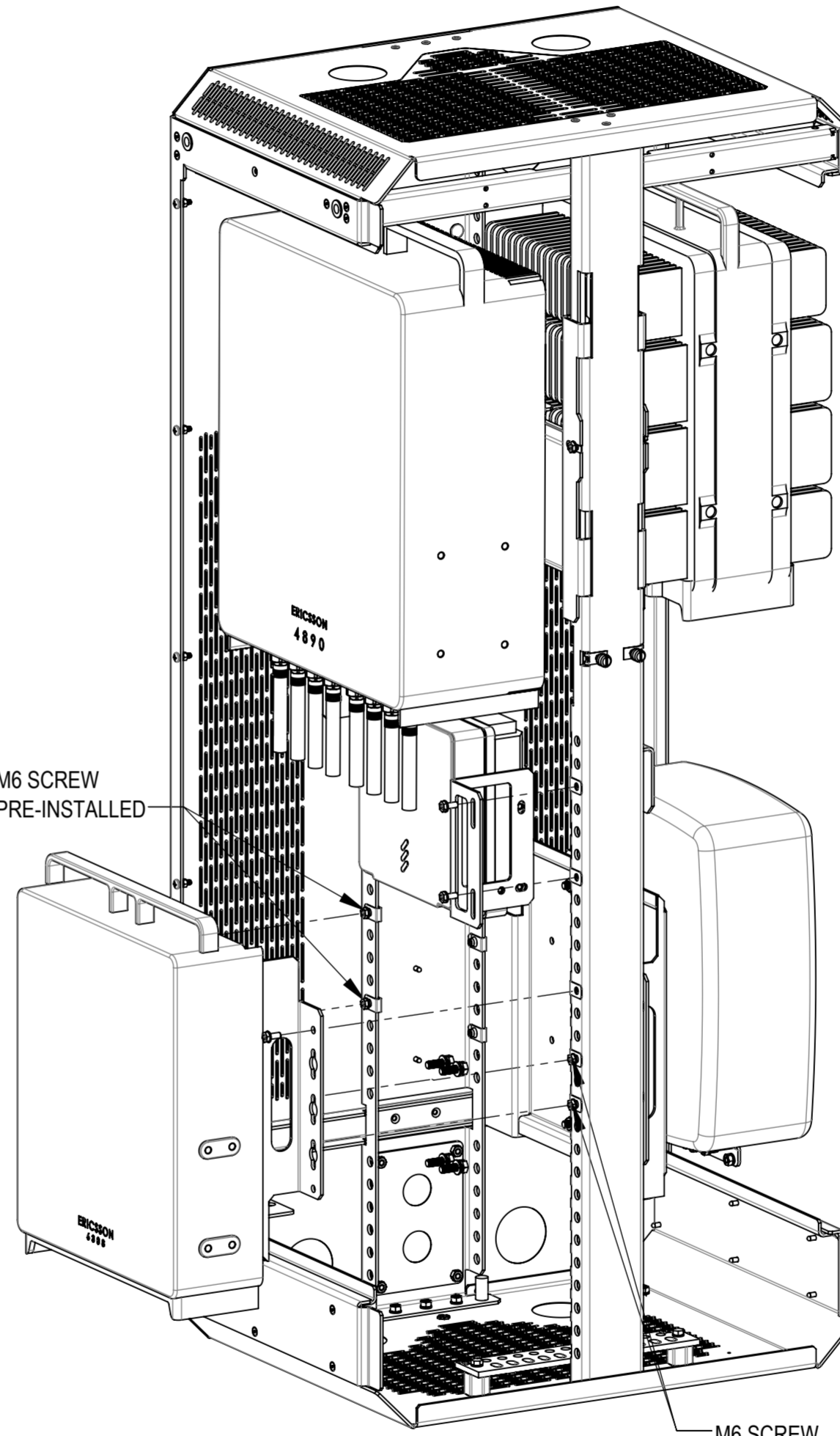

### 220x or 440x INSTALLATION: 6308 INSTALLATION:

INSTALL 220x or 440x WITH BRACKET ON ENCLOSURE AND SECURE BY 2 SETS OF M6 SCREW AND CLIP NUT

INSTALL 6308 WITH BRACKET ON ENCLOSURE AND SECURE BY 5 SETS OF M6 SCREW AND CLIP NUT



### FAN KITS INSTALLATION:

INSTALL THE FAN KIT 860661736-MV2-C03X TO THE TOP OF DBHP, SEE 860661736-MV2-C03-INSTALL

### 4449 (RIGHT) INSTALLATION:

- INSTALL SHOULDER BOLT IN TOP LOCATION AS SHOWN(SEE SHEET 4)
- HOLD RRU PANEL BETWEEN 45-90 DEG. AND INSERT BOTH TABS INTO SLOT ON UPRIGHT
- ROTATE PANEL INTO PLACE AND LIFT ONTO THE REAR UPRIGHT GUIDING PIN FOR SUPPORT
- SECURE PANEL WITH PROVIDED M6 HARDWARE
- REPEAT PROCESS FOR OPPOSITE SIDE RRU MOUNTING(IF APPLICABLE)

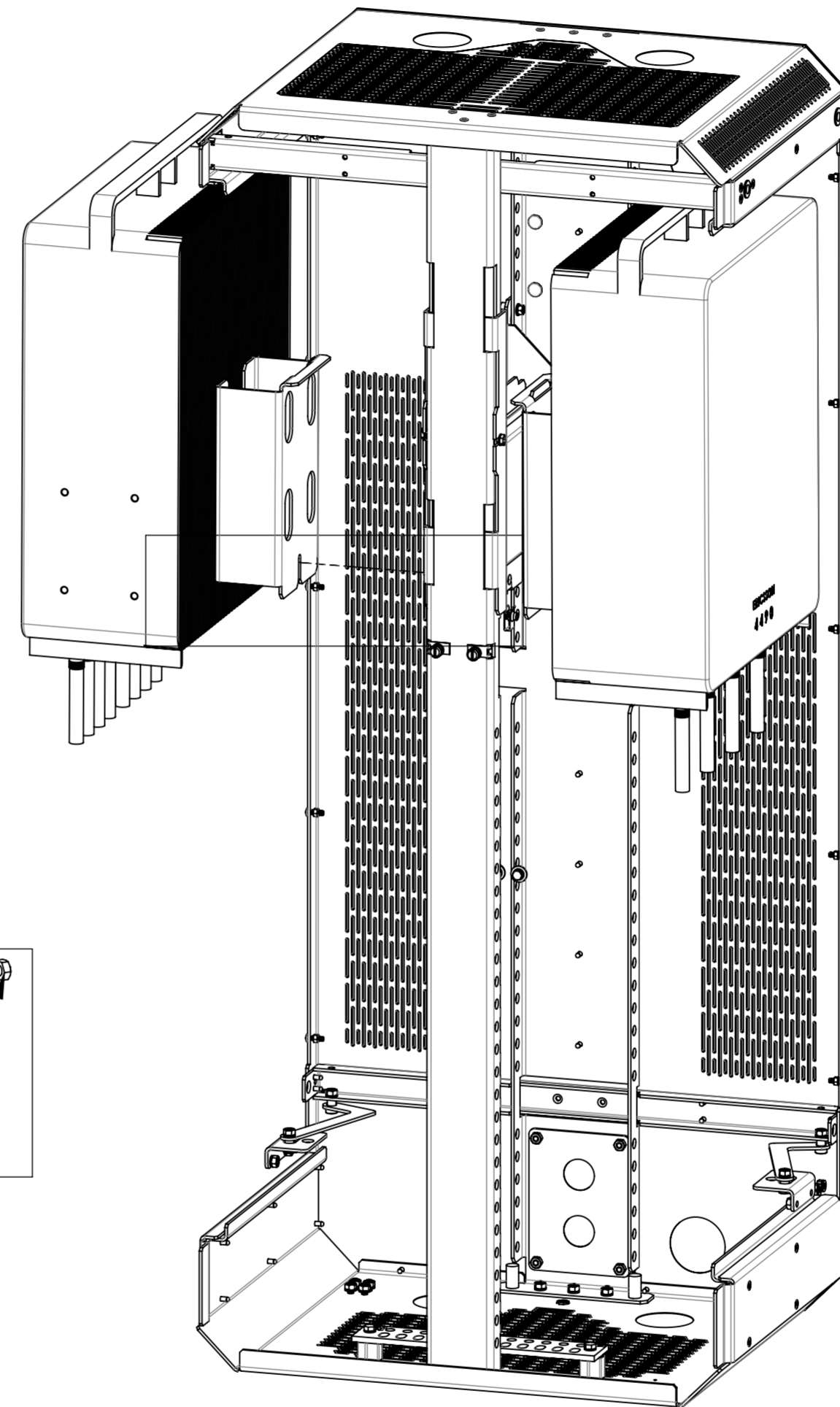
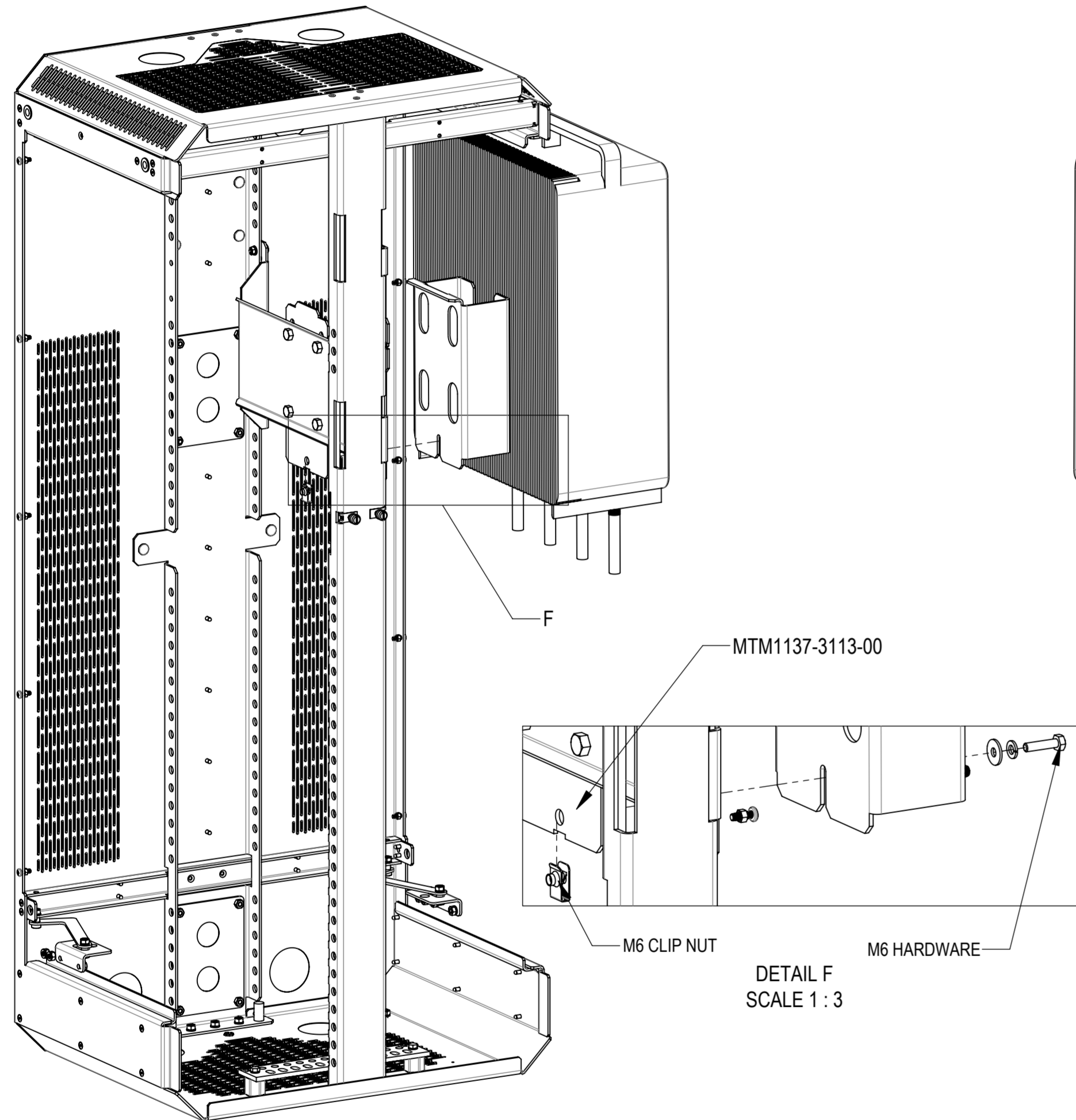

### 4490 INSTALLATION (RIGHT):

HANG 4490 WITH BRACKET ON MOUNT BRACKETS MTM1137-3113-00 AND SECURE BY 1 SETS OF M6 SCREW AND CLIP NUT

### 4890 INSTALLATION (LEFT):

HANG 4890 WITH BRACKET ON MOUNT BRACKETS MTM1137-3113-00 AND SECURE BY 1 SETS OF M6 SCREW AND CLIP NUT

## C4- 4890 & 4490 & 220x/440x & CFIT-FC24D0-RJ AND 6308

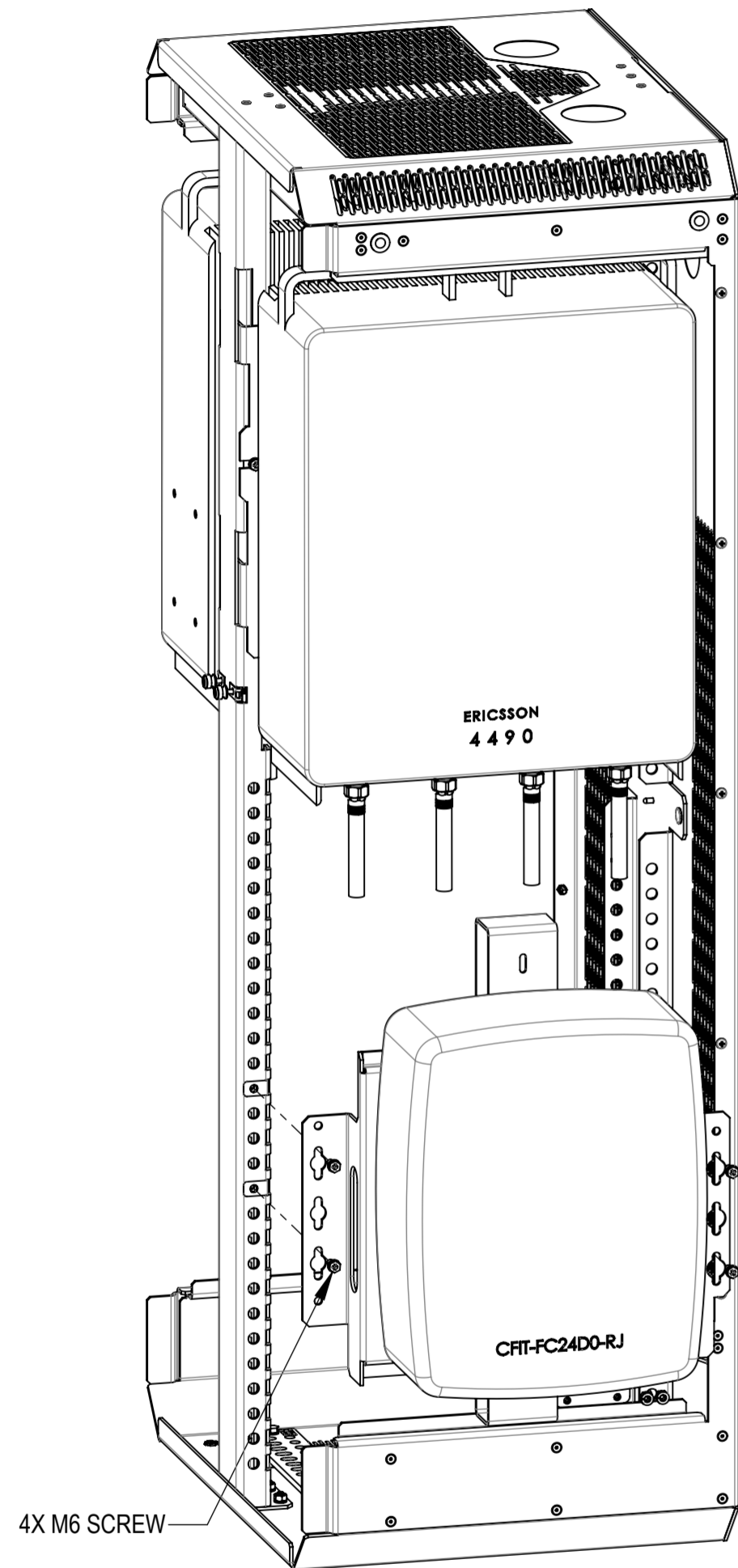

### CFIT-FC24D0-RJ INSTALLATION:

INSTALL CFIT-FC24D0-RJ WITH BRACKET ON ENCLOSURE AND SECURE BY 4 SETS OF M6 SCREW AND CLIP NUT

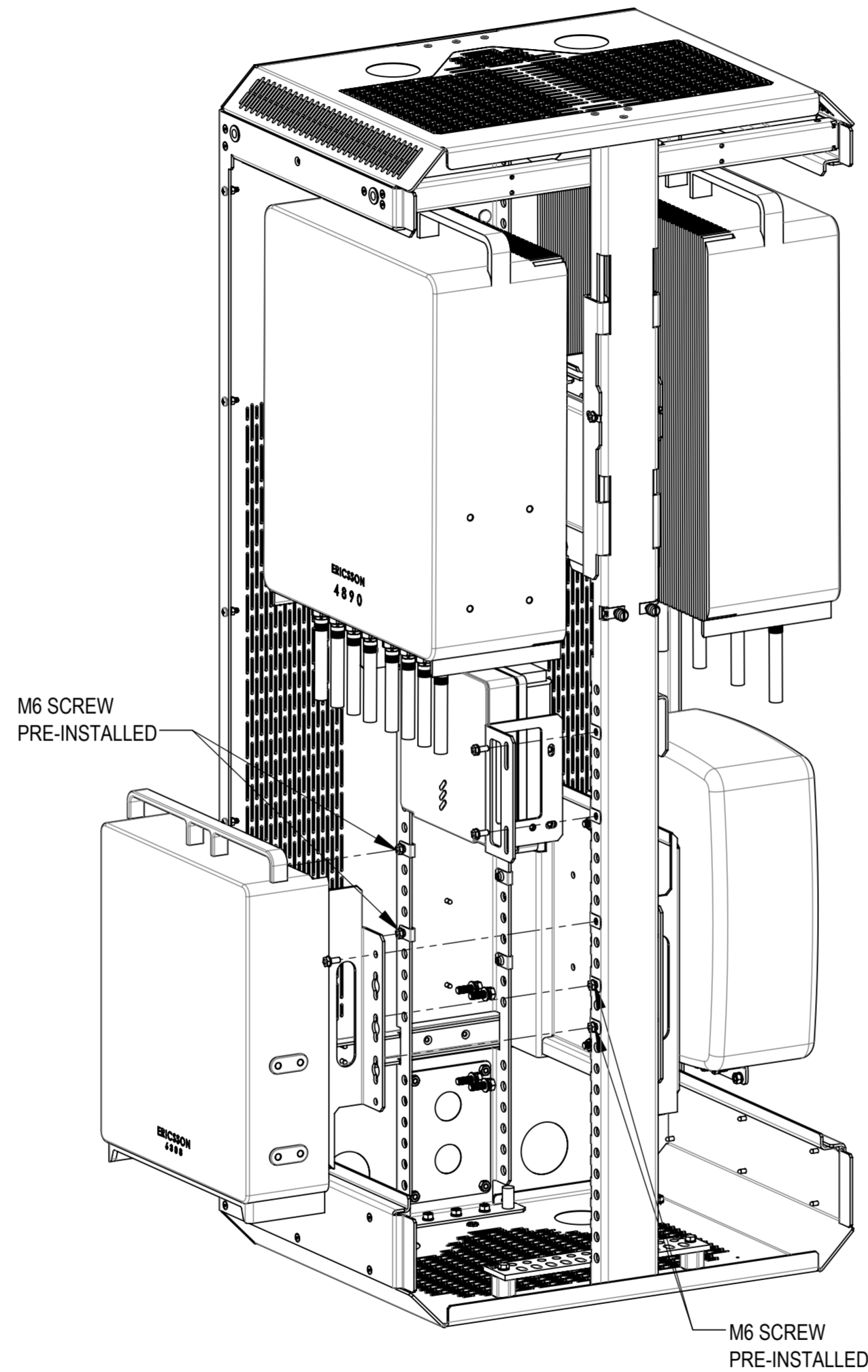

### 220x or 440x INSTALLATION: 6308 INSTALLATION:

INSTALL 220x or 440x WITH BRACKET ON ENCLOSURE AND SECURE BY 2 SETS OF M6 SCREW AND CLIP NUT

INSTALL 6308 WITH BRACKET ON ENCLOSURE AND SECURE BY 5 SETS OF M6 SCREW AND CLIP NUT

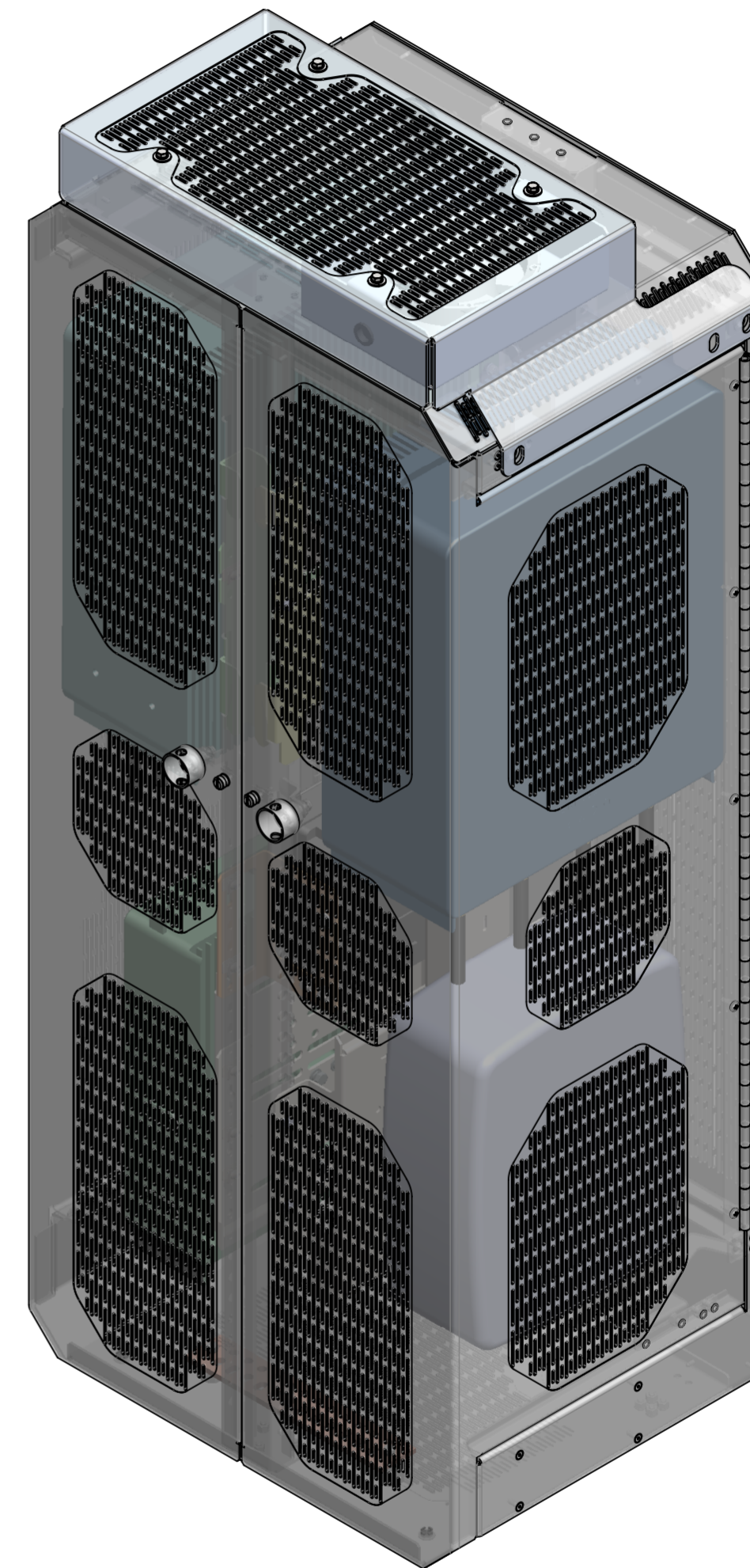

### FAN KITS INSTALLATION:

INSTALL THE FAN KIT 860661736-MV2-C03X TO THE TOP OF DBHP, SEE 860661736-MV2-C03-INSTALL