

REV	MCO	DWN	DATE
A	20262032	JSL	14-APR-09

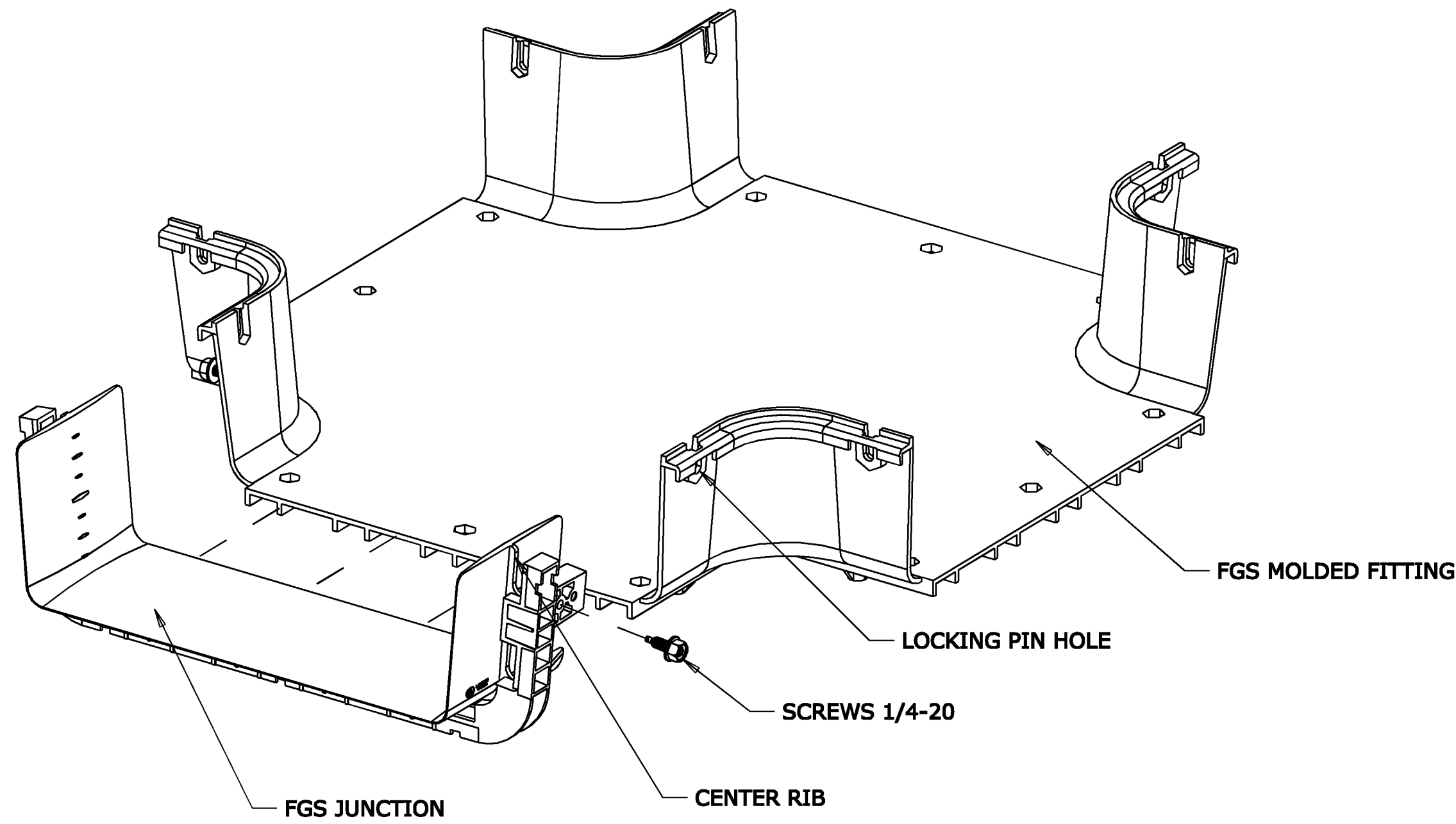

FIGURE 1

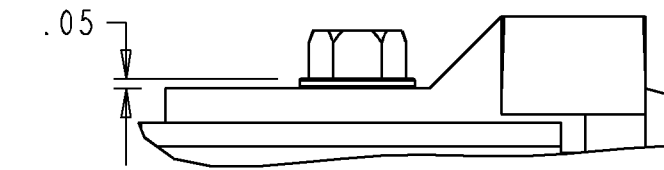
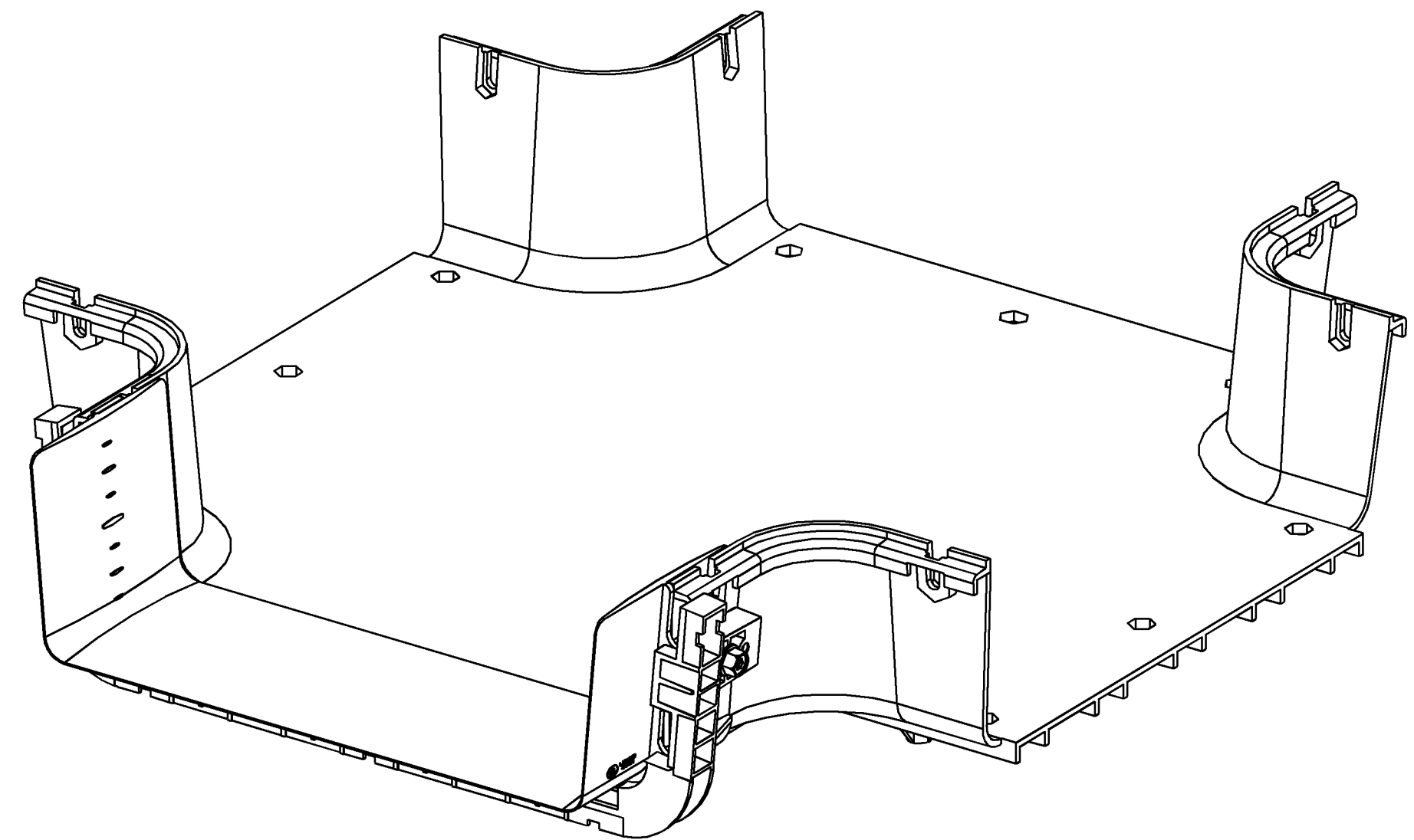

FIGURE 2



SCALE 0.375
COMPLETE ASSEMBLY

INSTALLATION NOTES:

1. SLIDE FGS COMPONENT INTO JUCTION UNTIL FIRMLY STATED AGAINST THE CENTER RIB. IF COMPONENT IS A MOLDED FITTING (FIGURE 1).
2. TIGHTEN (6) SCREWS SUCH THAT THE WASHER HEAD ON SCREW IS APPROXIMATELY 1/20" FROM SUPPORT ARM (SEE FIGURE 2). AFTER ALL SCREWS HAVE BEEN TIGHTENED TO 1/20" DIMENSION GO BACK AND TIGHTEN SCREWS UNTIL THE WASHER HEAD BOTTOMS OUT ON THE SUPPORT ARM.

FGSB-JUNC-F/I	BLACK
FGS-JUNC-F/I	YELLOW
CATALOG	COLOR



INFORMATION ON THIS DOCUMENT IS PROPRIETARY TO ADC AND SHALL NOT BE USED, COPIED, REPRODUCED OR DISCLOSED IN WHOLE OR IN PART WITHOUT WRITTEN CONSENT OF ADC.

ALL DIMS AND TOLERANCES ARE INCHES UNLESS OTHERWISE SPECIFIED

DO NOT SCALE DRAWING

TITLE
INSTALLATION DRAWING
4X12 FGS KIT JUNCTION

DRAWING NUMBER
1469945

SHT. 1 OF 1

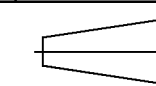
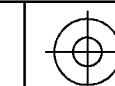

**DIMENSIONS IN INCHES
THIRD ANGLE PROJECTION**