

# CS-BL-R2

---

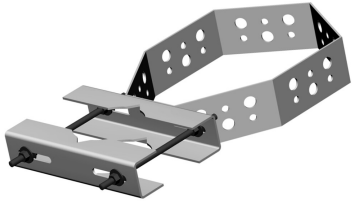

Cluster Support Bracket, 2 in to 5 in OD round member attachment

## Product Classification

**Product Type** Cluster Support Bracket

## General Specifications

**Cable Runs, quantity** 18

**Hole, quantity** 18

**Mounting** Cluster support

## Dimensions

**Height** 127 mm | 5 in

**Width** 381 mm | 15 in

**Length** 279.4 mm | 11 in

**Mounting Diameter, maximum** 127 mm | 5 in

**Mounting Diameter, minimum** 50.8 mm | 2 in

**Pipe Outer Diameter** 60.96 mm | 2.4 in

**Hole Size** 3/4 in | 7/16 in

# CS-BL-R2

## Outline Drawing

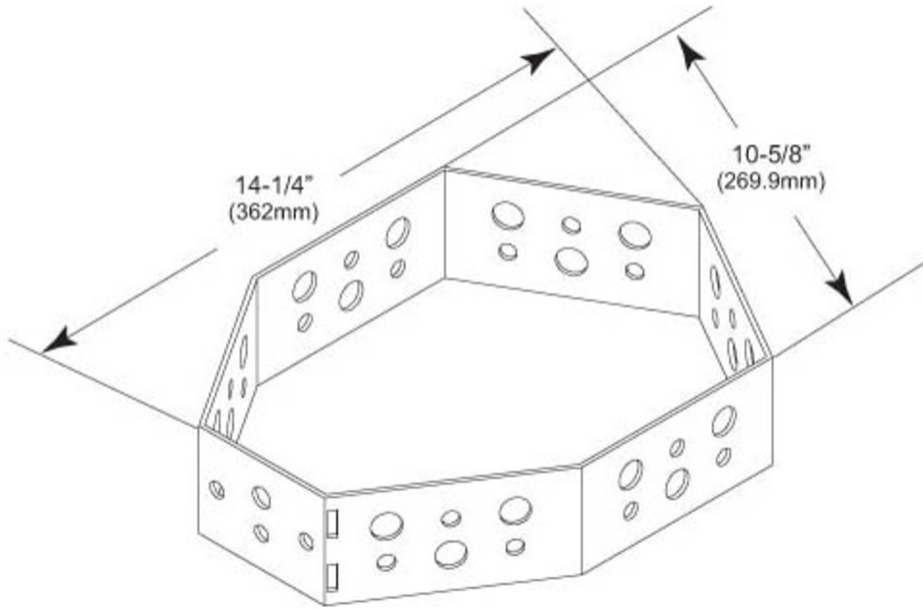

## Material Specifications

**Material Type** Hot dip galvanized steel

## Packaging and Weights

**Included** Brackets  
**Packaging quantity** 1  
**Weight, net** 3.6 kg | 7.937 lb

## Regulatory Compliance/Certifications

Agency	Classification
ISO 9001:2015	Designed, manufactured and/or distributed under this quality management system

## Included Products

CS-BL – Cluster Support Bracket, large version, angle member attachment